



Elite Series Serving Counters

EAGLE[®]
GROUP
Profit from the Eagle Advantage[®]

For More Information or to Request a Quotation
Contact Your Eagle Account Specialist

1-800-441-8440

For the ultimate solution for Custom Fabrication...

Elite Series Serving Counters

Elite Series Counters are an innovative way to design and build a counter that suits your needs as well as your design sensibilities. We created this line to enable customers to achieve the look they want without any sacrifice to functionality.

Start with the industry's widest range of products. Then add superior design and fabrication expertise. The result? Customization taken to a level all its own – delivered at a lower cost and in less time.

Our custom applications are comprised of specially fabricated equipment, pre-fab modular components ... or a combination of both.

They work their way quickly through an easy-yet-sophisticated design, approval and fabrication process, with equipment built to your exact specifications – even available pre-wired and pre-plumbed.



Elite Series Serving Counters

TOPS



STANDARD CONSTRUCTION

- 14 Gauge Standard
- Continuous Counter
- Standard 36" Width
- Sound Deadening Tape
- Top Turndown/Hemmed Edge

AVAILABLE OPTIONS* - TOPS

- Variety of Edges Available
- Radiused Tops
- Backsplash
- Solid Surface
- Quartz/Stone
- Other Custom Options Available



Elite Series Serving Counters



BASE

STANDARD CONSTRUCTION

- 18/300 Series Stainless Steel
- 18/300 Series Shelves
- Fully or Semi-Enclosed Base
- Stainless Steel Legs with 1-inch Adjustable Feet

AVAILABLE OPTIONS* - BASE

- Hinged Doors
- Sliding Doors
- Integral Utility Wall (Uni-Wall)
- Kick Plates
- Curb Base Provisions
- Prewired/Pre-Plumbed

Elite Series Serving Counters

FRONTS/DECOR

AVAILABLE OPTIONS

- Stainless Steel Fronts
- Laminate Panels
- Millwork/Wood Finishes
- Custom Tilework
- Decals
- Custom Wraps
- Laser Cutting & Etching
- Menu Boards
- Customized Design Package Options
- Customized Lighting
 - Accent Lighting
 - Toe Kick Lighting
 - Color Changing

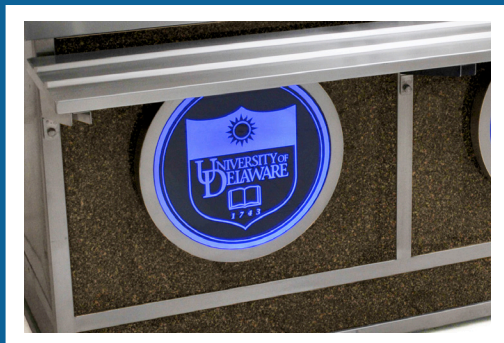
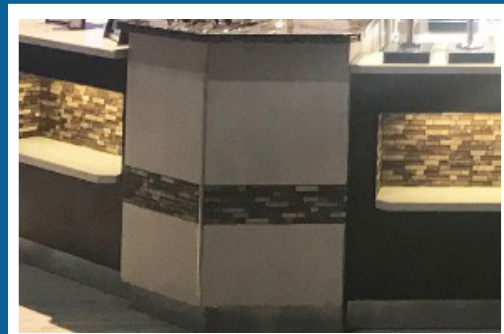
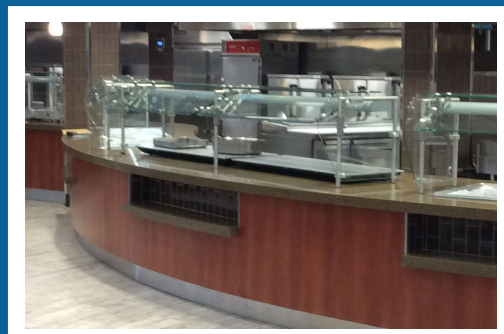
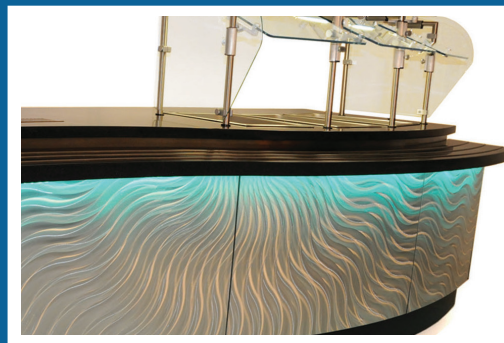

Elite Series Serving Counters

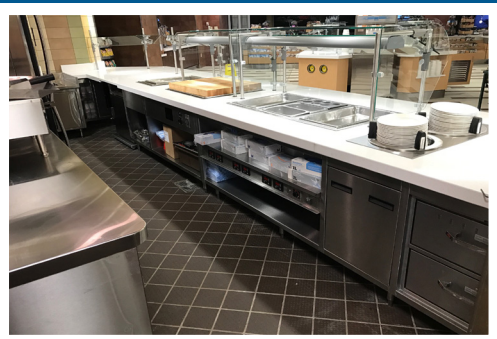

AVAILABLE OPERATIONAL EQUIPMENT

- Custom Refrigerated and Heated Bases
- Individual or Manifold Drains
- Hot Food Wells
- Mechanical or Ice-Cooled Cold Pans
- Dual Temperature Hot/Cold Pans
- Heated Surfaces/Frost Tops

AVAILABLE OPTIONS* - STORAGE

- Drawers
- Plate Shelves
- Work Shelves
- Wire Shelves

AVAILABLE OPTIONS* - TRAY SLIDES

- Inverted "V" Stainless Steel
- Square or Round Tubing/3 Bar
- Solid Surface
 - Quartz/Stone
- P-Lam Wood

Elite Series Serving Counters

FOOD SHIELDS

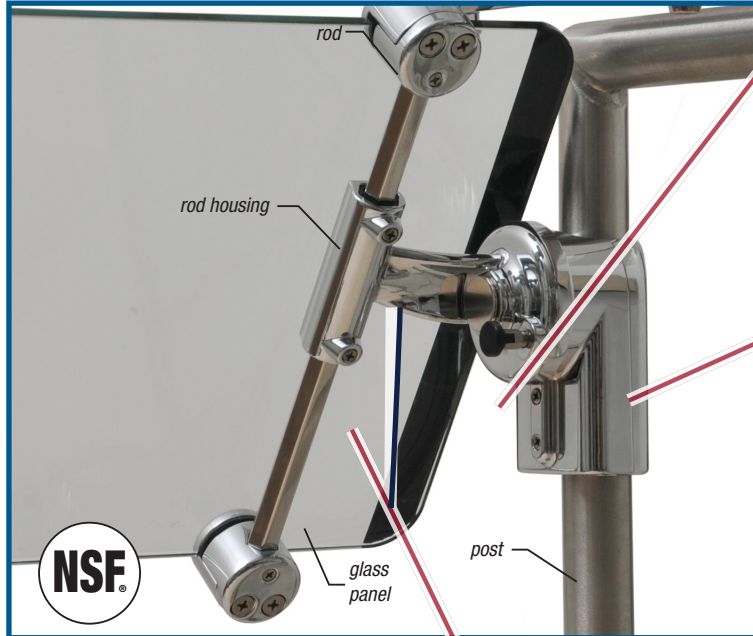

NOW PATENTED

Patent Nos. 9,538,868; 9,516,958;
9,339,131; 9,326,621; 9,723,935

Pull knob for angle adjustment of panels

Angle adjusts in 18° increments.

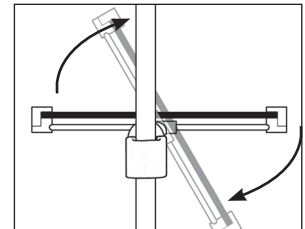

Split casting for removal or adjustment

Loosen set screws to separate split casting, allowing for removal of entire sneeze guard assembly and adjustment of height.

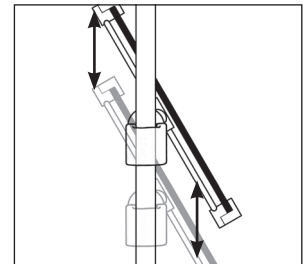

Set screws for adjustment of panels

When loosened, adjacent rod can slide freely inside the housing,

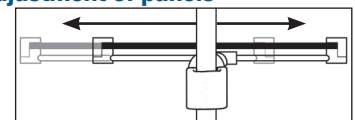

allowing for movement of panel without the need to move or take apart the split casting.

Eagle's Spec-SHIELD™ is an innovative, fully-adjustable sneeze guard / counter protector system. Glass is held in place with patented-design casting that allows for ease of glass adjustment as well as easy removal for cleaning. Angle of front glass adjusts in 18° increments, allowing for acceptance by local health codes as well as meeting NSF requirements.

SPECSHIELD FOOD SHIELDS

- No holes in glass panels allows for flexibility in mounting locations
- Front glass is adjustable vertically and may be rotated on 18° increments
- Top glass is adjustable horizontally.
- 1" stainless steel posts
- Mounting plates are cast aluminum with stainless steel covers
- Die cast aluminum with chrome finish brackets
- 3/4" radius corners on all glass panels
- Top glass is 3/8" thick
- Front glass is 1/4" thick. Optional 3/8" thick. Required for spans over 54".
- End glass included
- Units 60" and longer require mid post



AVAILABLE IN THE FOLLOWING CONFIGURATIONS

- Self-Service Food Guards
- Self-Service Buffet Food Guards
- Cafeteria Food Guards
- Cafeteria Carving Station Food Guards

Elite Series Serving Counters

SNEEZE GUARDS AVAILABLE IN THE FOLLOWING CONFIGURATIONS:

- Self-Service Food Guards

Single Tier
Model # SS-ST1

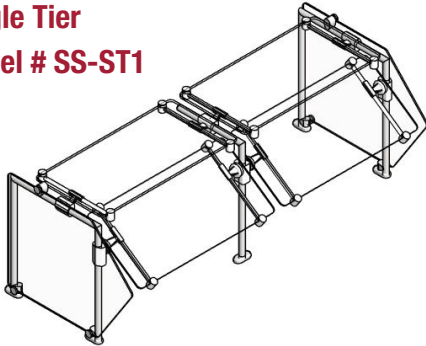

Double Tier
Model # SS-DT1

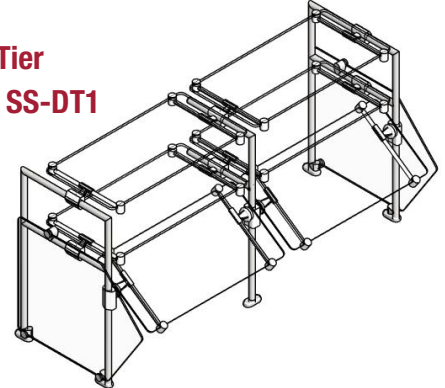

- Self-Service Buffet Food Guards

Single Tier
Model # SS-ST2

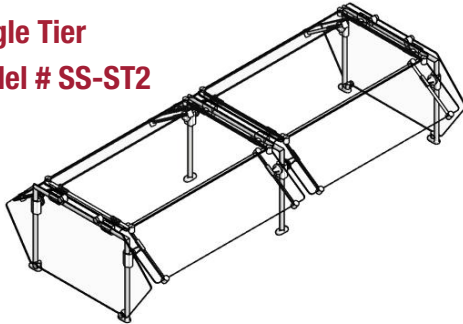

Double Tier
Model # SS-DT2

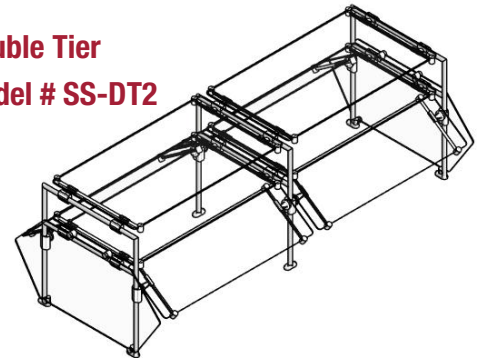

- Cafeteria Food Guards

with Glass Top
Model # CF-GT

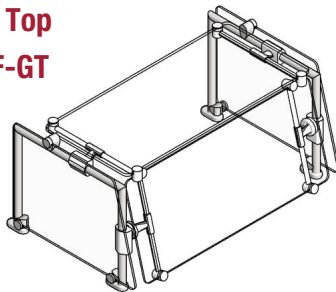

with Solid Top
Model # CF-MT

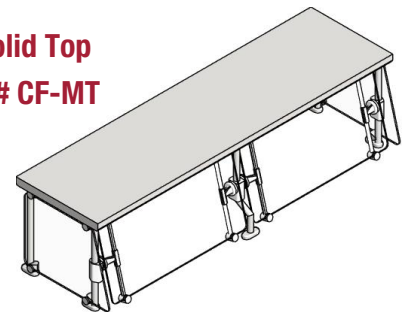

- Cafeteria Carving Station Food Guards

Short
Model # CF-NT

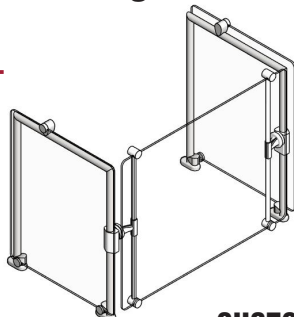

Double
Model # CF-NT

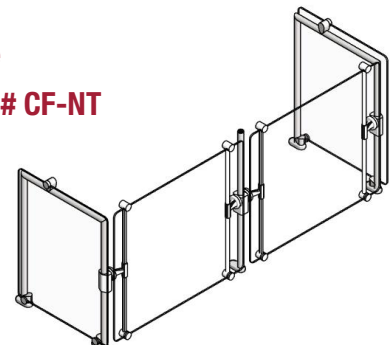

CUSTOM SNEEZE GUARDS AVAILABLE

Elite Series Serving Counters

UNI-WALL CONSTRUCTION

Eagle's proven Uni-Wall® concept allows the specifier or designer to layout counters, serving lines and bars that are custom built to NSF standards with factory pre-plumbed and UL wiring options.

Complete with industry leading heavy gauge galvanized Uni-Wall® stud framing assembly with utility and beverage line chase. The chase is accessible through standard lift-off front access panels.

Available in random lengths, straight or with a radius.



Installation time is reduced, compared to conventional 'built on-site counters'.

Each section of the Uni-Wall® is skidded before it is shipped from the factory. Each unit arrives with the necessary electrical lines run, plumbing in place and the beverage chase accessible and ready for immediate placement and hook-up when specified.



quotes@eaglegrp.com

Elite Series Serving Counters

Tubular Rear

Support Configuration

Typical material construction where available:

- Studs and interior wall heavy gauge galvanized construction
- Tops typically 14/3 stainless steel
- Typically front panels feature laminate over plywood
- Stainless steel kick plates
- Tubular stainless steel legs with stainless steel flanged feet
- Fixed tray slides feature solid raised ribbed stainless steel with tray lock provision

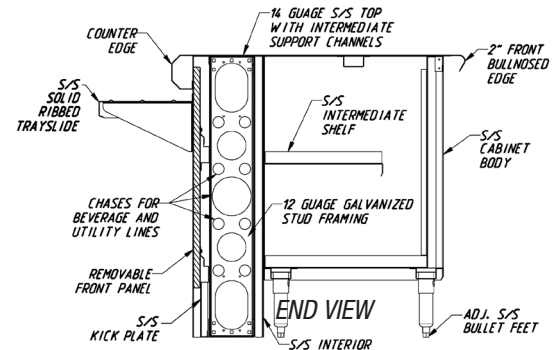
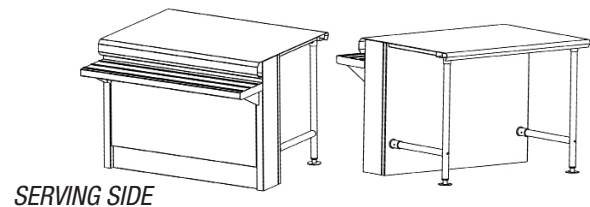

Wire Shelving Rear Support Configuration

- Shelving is chrome-plated, other finishes available
- Optional dividers and ledges available

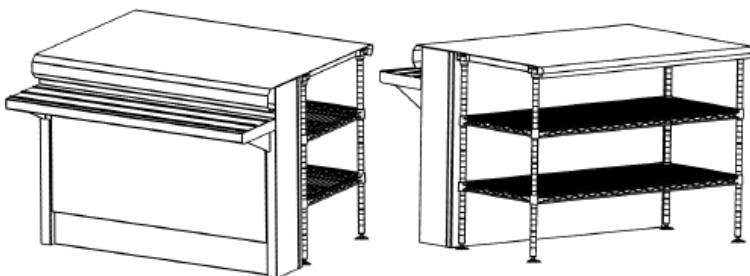

SERVING SIDE

OPERATOR'S SIDE

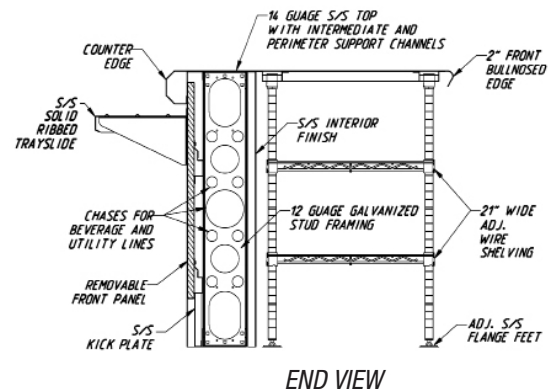

END VIEW

Cabinet Rear Support Configuration – Open Base

- Cabinet body features heavy gauge type 430 or 300 series stainless steel

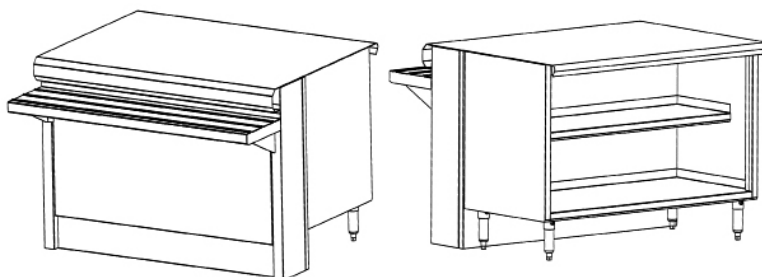

SERVING SIDE

OPERATOR'S SIDE

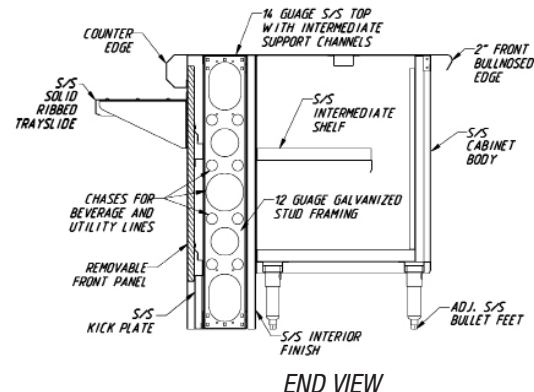

END VIEW

Elite Series Serving Counters

INSTALLATION SERVICES

- **Laser Templating Services** - Digital Measuring System Records Measurements Directly to CAD and Provides Relational Data
- **Expert Installers** – Fabricators, Welders, Electricians, Carpenters
- **Certified Installers** – For Stone, Quartz and Solid Surface – Install and Repair
- **Product Knowledge** – with Direct Contract to Factory
- **Full Installations** – Install Supervision and Field Modifications
- **Control Project from Start to Finish** - Design, Fabrication, Installation and Service



Elite Series Serving Counters



SpecFAB® IS HERE TO HELP!

We'll get your project off to a great start!

Eagle's SpecFAB® Quotations Team are product experts who can guide you in choosing, specifying and quoting the right Eagle products for your next project. We even have a dedicated Consultant Intermediary to assist you through the entire process.

EMAIL: quotes@eaglegrp.com

How It Works

It's easy to request a quotation from Eagle Group. Please include the following information with your request:

► **Tell us who and where you are**

Give us your name and/or the dealer name and city/state

► **Include project details**

Job name and location

► **Tell us the timeline**

Required date for quotation, the bid date for project and projected install date or timelines

► **Give us the details**

Consultant name, where applicable, any special considerations, send plans and/or specification related to the project



Eagle Group

100 Industrial Blvd. • Clayton, DE 19938

Toll Free: 1-800-441-8440

Fax: 302-653-2065

www.eaglegrp.com



Profit from the Eagle Advantage®

EG7502 Rev. 08/25