



Profit from the Eagle Advantage®

Specification Sheet

Short Form Specifications

Eagle Modular Bag-N-Box Wire Storage System, model _____. Patented QuadTruss® design chrome plated wire shelves for storage and use of syrup boxes. One slanted shelf with 1" front retaining ledge standard. 54" high chrome plated posts with adjustable feet.

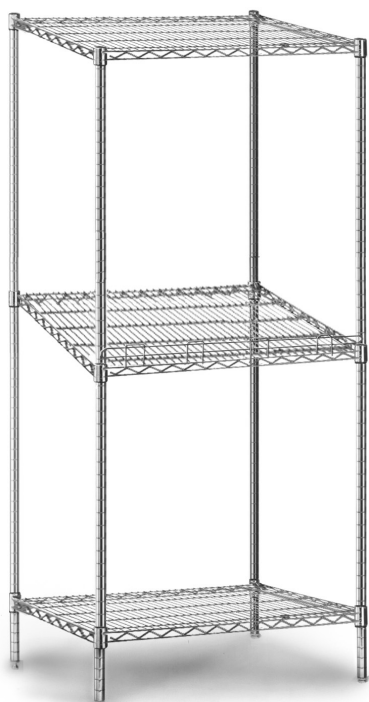

bag-n-box unit

Options / Accessories

- ☐ Additional slanted shelves
- ☐ Ledges

EAGLE GROUP

100 Industrial Boulevard, Clayton, DE 19938-8903 USA
Phone: 302-653-3000 • 800-441-8440 • Fax: 302-653-2065
www.eaglegrp.com
www.eaglegrp.com

For custom configuration or fabrication needs, contact our SpecFAB® Division.
Phone: 302-653-3000 • Fax: 302-653-2065 • e-mail: quotes@eaglegrp.com

Item No.: _____
Project No.: _____
S.I.S. No.: _____

Modular Bag-N-Box Systems

MODELS:

- ☐ B2136C
- ☐ 2B2136C
- ☐ 3B2136C
- ☐ B2148C
- ☐ 2B2148C
- ☐ 3B2148C

Design and Construction Features

- Patented QuadTruss® design (patent #5,390,803), making shelves up to 25% stronger and provides a retaining ledge for increased storage stability and product retention.
- For storage and usage of syrup boxes.
- Each unit has one slanted shelf to allow syrup to run to front of box.
- Front 1" (25mm) ledge is provided on slanted shelf.
- Wire shelves constructed of chrome plated mild steel.
- 54" (1372mm) posts have adjustable feet.
- Shelves adjustable on 1" (25mm) increments.
- All models are provided with a top and bottom straight wire shelf.

Certifications / Approvals



AutoQuotes





Profit from the Eagle Advantage®

Item No.: _____
 Project No.: _____
 S.I.S. No.: _____

Modular Bag-N-Box Systems

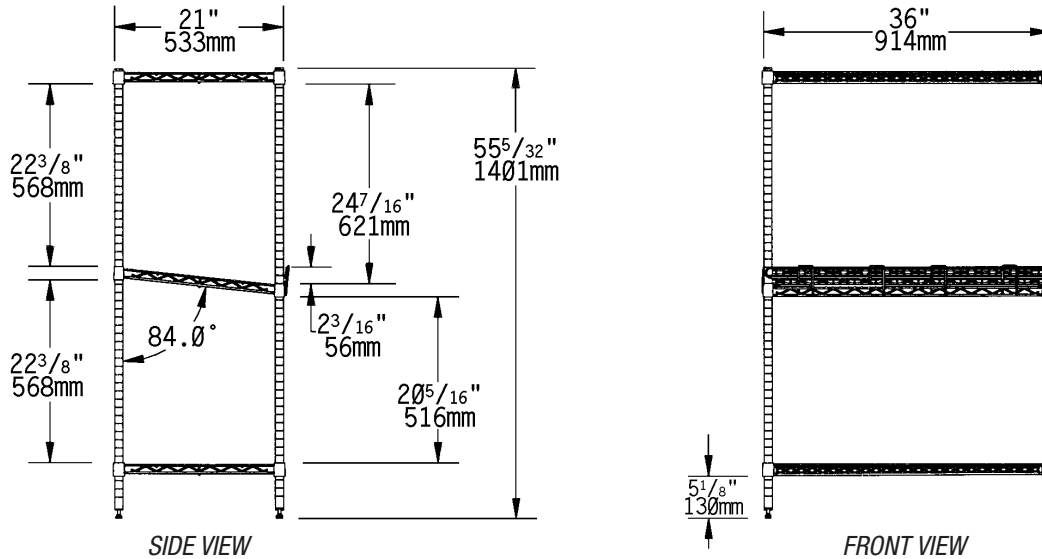

Note: model #B2136C shown

model #	# of shelves & description	width		length		height		weight	
		in.	mm	in.	mm	in.	mm	lbs.	kg
B2136C	1 slanted shelf; 2 straight shelves	21"	533	36"	914	54"	1372	46	20.9
2B2136C	1 slanted shelf; 3 straight shelves	21"	533	36"	914	54"	1372	57	25.9
3B2136C	1 slanted shelf; 4 straight shelves	21"	533	36"	914	54"	1372	68	30.8
B2148C	1 slanted shelf; 2 straight shelves	21"	533	48"	1219	54"	1372	55	24.9
2B2148C	1 slanted shelf; 3 straight shelves	21"	533	48"	1219	54"	1372	69	31.3
3B2148C	1 slanted shelf; 4 straight shelves	21"	533	48"	1219	54"	1372	83	37.6

Optional Ledges

Chrome-plated.

1" (25mm) LEDGES			4" (102mm) LEDGES			length
model #	lbs.	kg	model #	lbs.	kg	
L14-1C	0.2	0.1	L14-4C	0.8	0.4	14" 356
L18-1C	0.3	0.1	L18-4C	0.9	0.4	18" 457
L21-1C	0.4	0.2	L21-4C	1.0	0.5	21" 533
L24-1C	0.5	0.2	L24-4C	1.2	0.5	24" 610
L30-1C	0.7	0.3	L30-4C	1.4	0.6	30" 762
L36-1C	0.9	0.4	L36-4C	1.6	0.7	36" 914
L42-1C	1.1	0.5	L42-4C	1.8	0.8	42" 1067
L48-1C	1.3	0.8	L48-4C	2.0	0.9	48" 1219

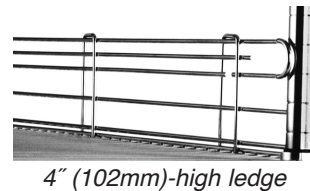
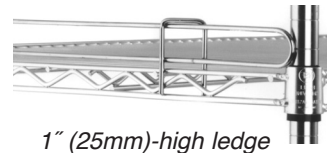

EAGLE GROUP

100 Industrial Boulevard, Clayton, DE 19938-8903 USA

Phone: 302-653-3000 or 800-441-8440 • Fax: 302-653-2065

www.eaglegrp.com • www.eaglehmc.com

Printed in U.S.A.
 ©2025 by Eagle Group

Rev. 02/25

Spec sheets available for viewing, printing or downloading from our online literature library at our websites

Although every attempt has been made to ensure the accuracy of the information provided, we cannot be held responsible for typographical or printing errors. Information and specifications are subject to change without notice. Please confirm at time of order.