



Profit from the Eagle Advantage®

Specification Sheet

Short Form Specifications

Eagle Raised Deck Cool Trough® with Grating, model _____ . Features subway-style gray fiberglass or stainless steel grating. Unit constructed of 14/304 stainless steel all-welded construction. Built-in pitch towards a 4" drain with removable perforated basket. Integral mechanical temperature sensor maintains water temperature of 130°F or less. Anti-Splash units also available.

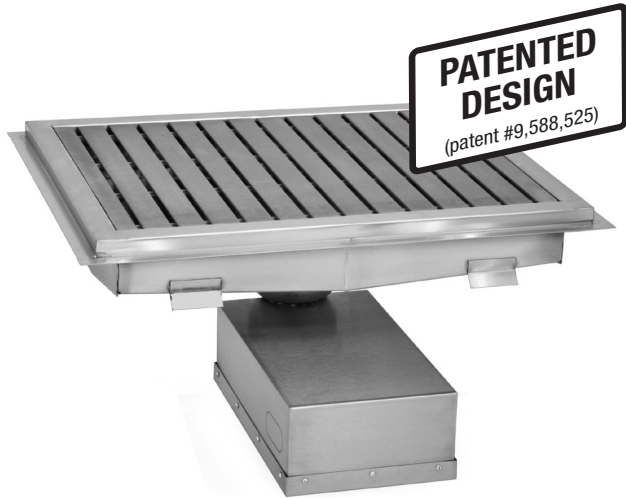

model #WTFTRD-2430-FG-ADA
(shown with optional ADA-compliant grating)

Section 701.7 of the International Plumbing Code mandates that water entering a drainage system cannot exceed 140°F, which could cause problems with PVC pipes and other safety and environmental issues. The Cool Trough® is designed to activate the temperature sensor at 130°F and turn off the mixing valve at 120°F, thus using water only when required.

Many facilities which utilize equipment such as boilers, humidifiers, sterilizers, and commercial equipment typically produce drain water over 140°F. The water must be cooled, or "tempered," before entering drain lines. The operation of the Cool Trough® requires no additional steps for the operator. It only generates economic rewards by extending the life of the drainage system.

Also, because the valve is mechanically actuated, there is no need for electrical connection, which means there is no chance of an electrical component failure.

Hook a cold water line to the shutoff valve provided, and protection for your drain lines is ensured.

Item No.: _____
Project No.: _____
S.I.S. No.: _____

Raised Deck Cool Trough® Water Tempering Systems

MODELS:

- | | | |
|--|--|--|
| <input type="checkbox"/> WTFTRD-1218-* | <input type="checkbox"/> WTFTRD-1824-* | <input type="checkbox"/> WTFTRD-2430-* |
| <input type="checkbox"/> WTFTRD-1224-* | <input type="checkbox"/> WTFTRD-1830-* | <input type="checkbox"/> WTFTRD-2436-* |
| <input type="checkbox"/> WTFTRD-1230-* | <input type="checkbox"/> WTFTRD-1836-* | <input type="checkbox"/> WTFTRD-2442-* |
| <input type="checkbox"/> WTFTRD-1236-* | <input type="checkbox"/> WTFTRD-1848-* | <input type="checkbox"/> WTFTRD-2448-* |
| <input type="checkbox"/> WTFTRD-1248-* | <input type="checkbox"/> WTFTRD-1860-* | <input type="checkbox"/> WTFTRD-2460-* |
| <input type="checkbox"/> WTFTRD-1260-* | <input type="checkbox"/> WTFTRD-1872-* | <input type="checkbox"/> WTFTRD-2472-* |
| <input type="checkbox"/> WTFTRD-1272-* | <input type="checkbox"/> WTFTRD-2424-* | |

* See chart on back for complete model numbers.

Design & Construction Features

- Integral mechanical temperature sensor maintains water temperature of 130°F or less.
- Built-in pitch towards drain ensures complete drainage.
- Lift-out grating available in anti-slip gray fiberglass or stainless steel.
- 4" (76mm) diameter drain with removable basket style strainer.
- No electrical connection required.
- Shutoff valve provided accepts 1" water line *.
- Reduced pressure valve—includes two check valves.
- Stainless steel anchor clip.
- 14 gauge stainless steel access compartment allows access from below.
- Troughs available in widths ranging from 12" to 24" (305 to 610mm).
- 18" to 72" (457 to 1829mm) lengths available.
- Anti-Splash Troughs available—see spec sheet #EG25.05B.

* Water supply and waste line connections to be provided by licensed plumbing contractor.

EAGLE GROUP

100 Industrial Boulevard, Clayton, DE 19938-8903 USA
Phone: 302-653-3000 • 800-441-8440 • Fax: 302-653-2065
www.eaglegrp.com
www.eaglehmc.com

For custom configuration or fabrication needs, contact our SpecFAB® Division.
Phone: 302-653-3000 • Fax: 302-653-2065 • e-mail: quotes@eaglegrp.com



EG25.05A Rev. 02/25

Spec sheets available for viewing, printing or downloading from our online literature library at our websites

Eagle Foodservice Equipment, Eagle MHC, and SpecFAB® are divisions of Eagle Group. ©2025 by the Eagle Group



Profit from the Eagle Advantage®

Raised Deck Cool Trough® Water Tempering Systems

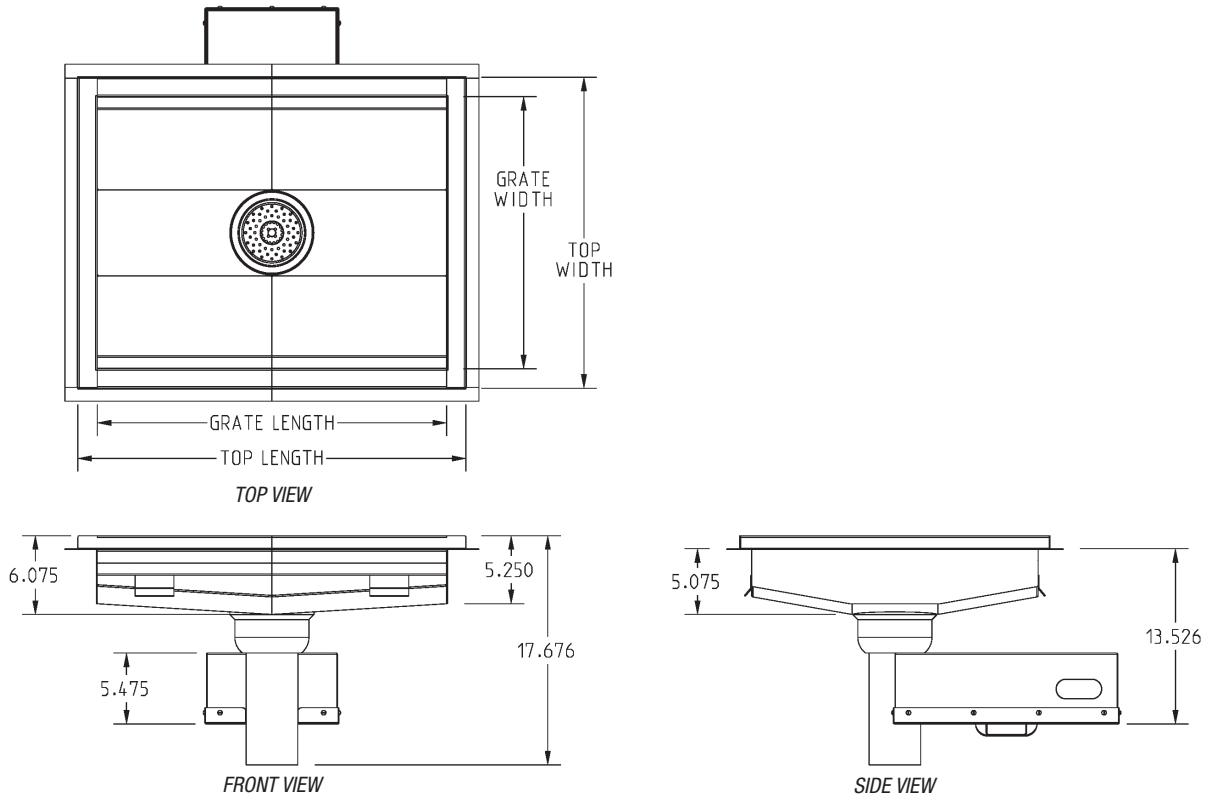

TOP width x length		GRATING width x length		VOLUME gallons	WITH GRAY FIBERGLASS GRATING	WITH STAINLESS STEEL GRATING
in.	mm	in.	mm		model #	model #
12" x 18"	432 x 457	9" x 15"	229 x 381	2.8	WTFTRD-1218-FGG	WTFTRD-1218-SG
12" x 24"	432 x 610	9" x 21"	229 x 533	3.9	WTFTRD-1224-FGG	WTFTRD-1224-SG
12" x 30"	432 x 762	9" x 27"	229 x 686	5.0	WTFTRD-1230-FGG	WTFTRD-1230-SG
12" x 36"	432 x 914	9" x 33"	229 x 838	6.1	WTFTRD-1236-FGG	WTFTRD-1236-SG
12" x 48"	432 x 1219	9" x 45"	229 x 1143	8.3	WTFTRD-1248-FGG	WTFTRD-1248-SG
12" x 60"	432 x 1524	9" x 57"	229 x 1448	10.5	WTFTRD-1260-FGG	WTFTRD-1260-SG
12" x 72"	432 x 1829	9" x 69"	229 x 1753	12.8	WTFTRD-1272-FGG	WTFTRD-1272-SG
18" x 24"	432 x 610	15" x 21"	381 x 533	6.5	WTFTRD-1824-FGG	WTFTRD-1824-SG
18" x 30"	432 x 762	15" x 27"	381 x 686	8.3	WTFTRD-1830-FGG	WTFTRD-1830-SG
18" x 36"	432 x 914	15" x 33"	381 x 838	10.2	WTFTRD-1836-FGG	WTFTRD-1836-SG
18" x 48"	432 x 1219	15" x 45"	381 x 1143	13.9	WTFTRD-1848-FGG	WTFTRD-1848-SG
18" x 60"	432 x 1524	15" x 57"	381 x 1448	17.6	WTFTRD-1860-FGG	WTFTRD-1860-SG
18" x 72"	432 x 1829	15" x 69"	381 x 1753	21.3	WTFTRD-1872-FGG	WTFTRD-1872-SG
24" x 24"	432 x 610	21" x 21"	533 x 533	9.1	WTFTRD-2424-FGG	WTFTRD-2424-SG
24" x 30"	432 x 762	21" x 27"	533 x 686	11.7	WTFTRD-2430-FGG	WTFTRD-2430-SG
24" x 36"	432 x 914	21" x 33"	533 x 838	14.3	WTFTRD-2436-FGG	WTFTRD-2436-SG
24" x 42"	432 x 1068	21" x 39"	533 x 991	16.8	WTFTRD-2436-FGG	WTFTRD-2436-SG
24" x 48"	432 x 1219	21" x 45"	533 x 1143	19.4	WTFTRD-2448-FGG	WTFTRD-2448-SG
24" x 60"	432 x 1524	21" x 57"	533 x 1448	24.6	WTFTRD-2460-FGG	WTFTRD-2460-SG
24" x 72"	432 x 1829	21" x 69"	533 x 1753	29.8	WTFTRD-2472-FGG	WTFTRD-2472-SG

ADA-compliant Grating available! Provides a more solid walking area, and objects are less likely to fall through. Offered in gray only. Available for both Cool Trough® with Fiberglass AND with Stainless Steel Grating! For fiberglass, replace suffix -FGG with suffix -FG-ADA. Example: WTFTRD-1224-FG-ADA. For stainless steel, add suffix -ADA. Example: WTFTRD-1224-SG-ADA.

EAGLE GROUP

100 Industrial Boulevard, Clayton, DE 19938-8903 USA

Phone: 302-653-3000 or 800-441-8440 • Fax: 302-653-2065

www.eaglegrp.com • www.eaglehmc.com

Printed in U.S.A.
©2025 by Eagle Group

Rev. 02/25

Spec sheets available for viewing, printing or downloading from our online literature library at our websites

Although every attempt has been made to ensure the accuracy of the information provided, we cannot be held responsible for typographical or printing errors. Information and specifications are subject to change without notice. Please confirm at time of order.