

Bottle Filler Stations

INSTALLATION INSTRUCTIONS

CAUTION

INSPECT CONTENTS IMMEDIATELY AND FILE CLAIM WITH DELIVERING CARRIER FOR ANY DAMAGE. **SAVE YOUR BOX AND ALL PACKING MATERIALS.** YOU ARE RESPONSIBLE FOR DAMAGE TO YOUR UNIT IF RETURNED IMPROPERLY PACKED.

Thank you for your purchase. Before assembly, read this instruction sheet carefully. After reading, be sure to store this instruction in a safe place, should it be needed for future reference.

Please note before installation:

- Attach faucet to unit, per faucet instructions.
- Attach drain to unit, per drain instructions.
- If your bottle filler station came with water filter, attach per water filter instructions.
- Instructions show 12'-long single unit, but also pertain to 28'-long double units.

Step 1 - Attach z-bracket to wall.

Use a level for straightness.

(Note: Mounting hardware not included.)

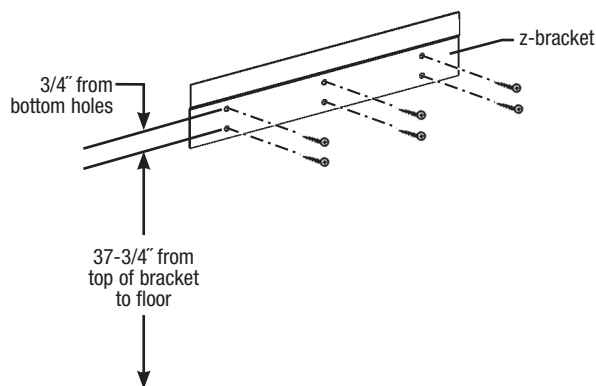

Step 2 - Center and hang unit onto z-bracket.

Hook the back of the unit onto the wall-mounted z-bracket. Adjust to desired location.

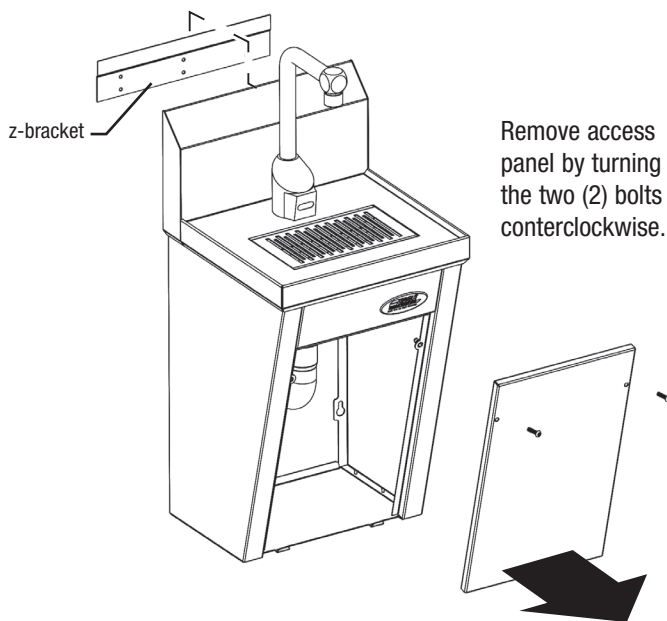

(continued on back page)

EG10127 Revised 10/24

Bottle Filler Stations

INSTALLATION INSTRUCTIONS

Step 3 - Secure sink to wall*.

(Note: Mounting hardware* not included.)

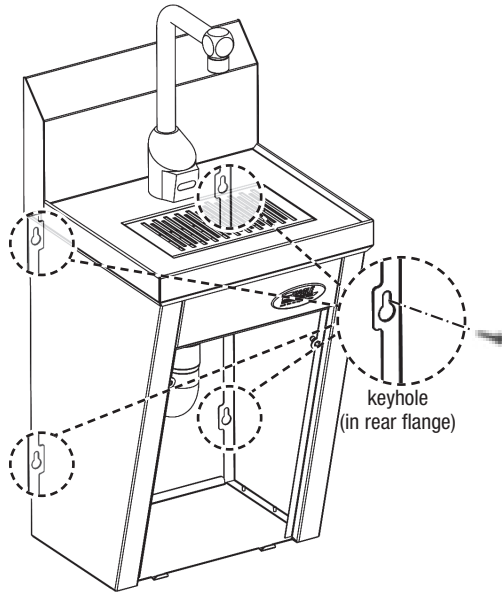

* IMPORTANT NOTE:

Depending on construction of wall, bottle filler station should be attached to wall studs, in-wall grounds (wall backing) of plywood or sheet metal, or solid part of brick or concrete wall with appropriate fasteners. Failure to use appropriate fasteners could result in collapse and personal injury. Eagle Group cannot be held responsible for failure of the device or any other devices due to improper installation. It is your responsibility to make certain the mounting surface and method of mounting are suitable to support the weight of this unit.

Step 4 - Attach control module.

- Attach water supply line to inlet connection on control module, as shown.
- Run electrical power cord through grommet. Connect to control module, as shown.
- Check for leaks in both supply and drain lines.

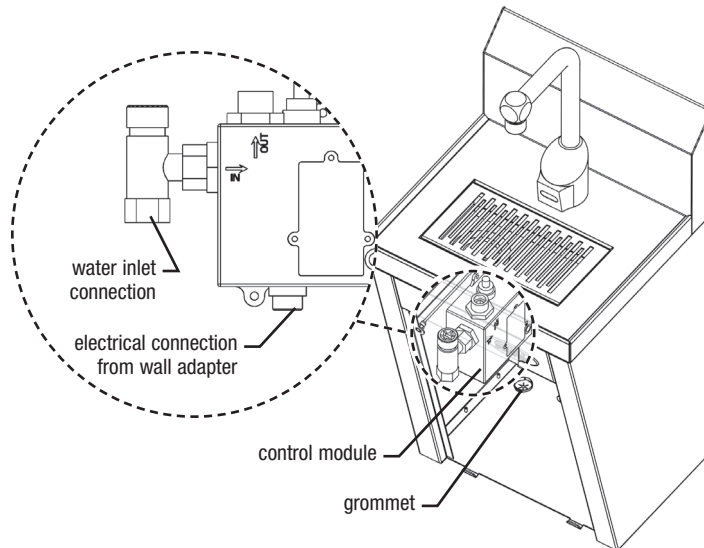

Installation is complete. (End)