



Profit from the Eagle Advantage®

Specification Sheet

Short Form Specifications

Eagle Group Spec-Bar® Drop-In Glass Rinser Trough, model #_____. Heavy gauge type 300 stainless steel drain trough. Glass rinser features a 4½"-diameter actuation disk, comes with 12' long braided stainless hose with a ¾" compression fitting and a ½" FIP fitting. Inline, preset pressure regulator provided. Removable stainless steel trough cover. ½" drain with barbed drain fitting provided.

Item No.:	_____
Project No.:	_____
S.I.S. No.:	_____

Spec-Bar® Drop-In Glass Rinser Troughs

MODELS:

- DIGRT-6
- DIGRT-12
- DIGRT-18
- DIGRT-24

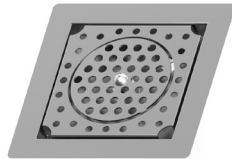

#DIGRT-6

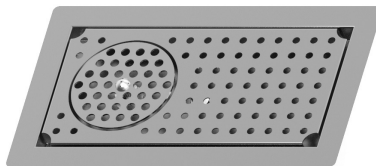

#DIGRT-12

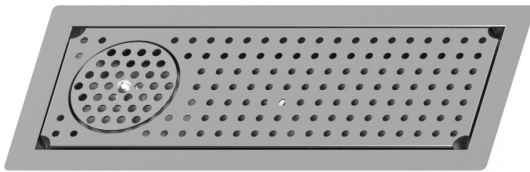

#DIGRT-18

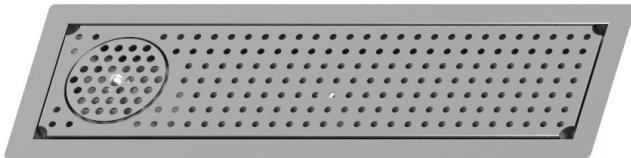

#DIGRT-24

Design & Construction Features:

- Type 300 series stainless steel construction
- 4½"-diameter actuation disk
- ½" FNPT stainless steel fitting welded to pan for drain
- Inline preset pressure regulator
- Removable stainless steel trough cover
- Lengths available range from 6" to 24"

EAGLE GROUP

100 Industrial Boulevard, Clayton, DE 19938-8903 USA
 Phone: 302-653-3000 • 800-441-8440 • Fax: 302-653-2065
www.eaglegrp.com
www.eaglemhc.com



For custom configuration or fabrication needs, contact our **SpecFAB® Division**.
 Phone: 302-653-3000 • Fax: 302-653-2065 • e-mail: quotes@eaglegrp.com

EG40.65 Rev. 05/24

Spec sheets available for viewing, printing or downloading from our online literature library at our websites



Profit from the Eagle Advantage®

Item No.: _____
 Project No.: _____
 S.I.S. No.: _____

Spec-Bar® Drop-In Glass Rinser Troughs

#DIGRT-6

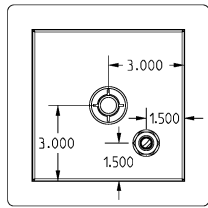
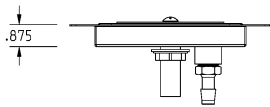
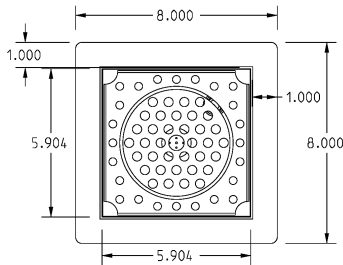

**CUTOUT DIMENSIONS
 (width x length)**
 6 1/4" x 6 1/4"
 (159 x 159mm)

#DIGRT-12

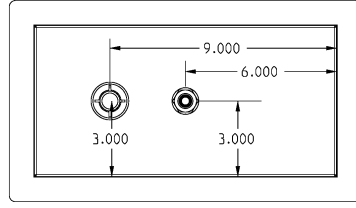
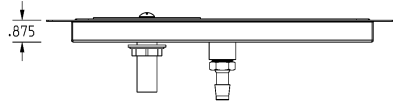
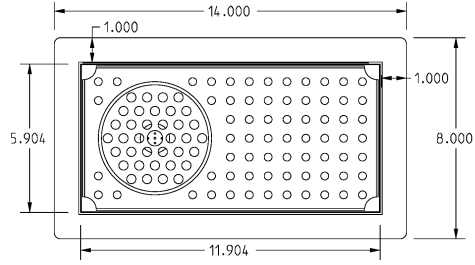

**CUTOUT DIMENSIONS
 (width x length)**
 6 1/4" x 12 1/4"
 (159 x 311mm)

#DIGRT-18

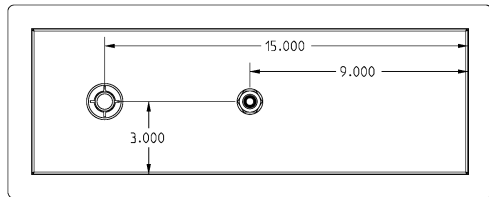
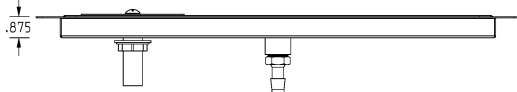
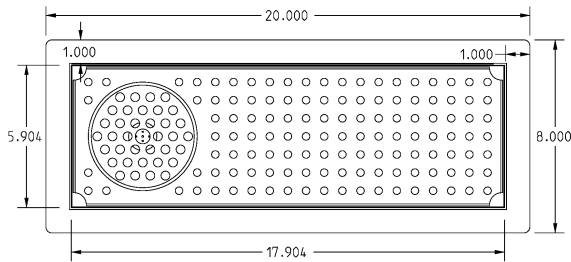

**CUTOUT DIMENSIONS
 (width x length)**
 6 1/4" x 18 1/4" (159 x 464mm)

#DIGRT-24

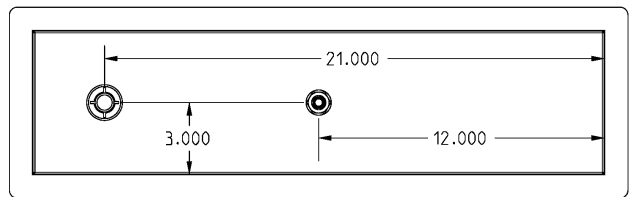
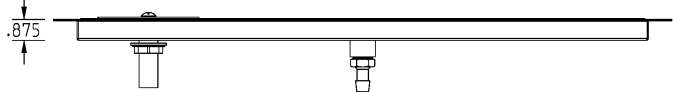
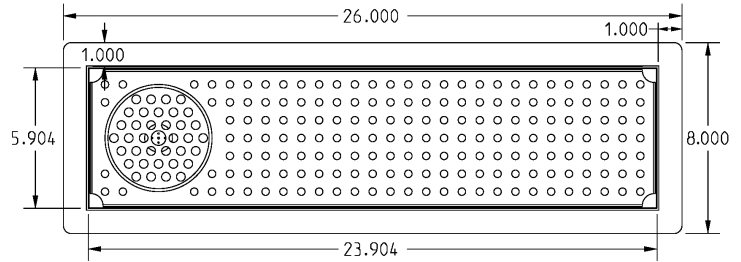

**CUTOUT DIMENSIONS
 (width x length)**
 6 1/4" x 24 1/4" (159 x 616mm)

EAGLE GROUP

100 Industrial Boulevard, Clayton, DE 19938-8903 USA
 Phone: 302-653-3000 or 800-441-8440 • Fax: 302-653-2065
 www.eaglegrp.com • www.eaglehmc.com

Printed in U.S.A.
 ©2024 by Eagle Group

Rev. 05/24

Spec sheets available for viewing, printing or downloading from our online literature library at our websites

Although every attempt has been made to ensure the accuracy of the information provided, we cannot be held responsible for typographical or printing errors. Information and specifications are subject to change without notice. Please confirm at time of order.