



Profit from the Eagle Advantage®

Phone: (800) 441-8440 • (302) 653-3000

FAX: (302) 653-2065

Product Announcement

Short Form Specifications

Eagle Group SPEC-BAR® Portable Bar, model #SBPB-CWS-6. Welded 1-1/2" type 300 stainless steel square tubular base construction. 80" length, 32" wide, 48" high with 34" work height. Fully mobile - standard 4" poly tread casters with brake. Ice bin is 15" x 19" x 8", with 1-1/2" drain. Workboard is 48" with 1-1/2" drain. Speed rail is full length. Storage for four (4) 20" x 20" x 4" glass racks. Ice chest and workboard plumbed independently.

Item #:	_____
Model #:	_____
Project #:	_____
SIS #:	_____

EG8215CWS Rev. 01/23

New SPEC-BAR® Portable Bar with Workboard

Design & Construction Features:

- Welded 1½" type 300 stainless steel square tubular base construction
- Stainless steel top with marine edge.
- 4" casters with brake
- 15" x 19" x 8" ice chest with 1-1/2" drain.
- 48" workboard with top embossments and 1-1/2" drain
- Full length double speed rail
- Storage for four 20" x 20" x 4" glass racks

Options

- Solid surface bar top
- Lift-up stainless steel end countertops
- Laminate or powder coated panels



SPEC-BAR® Portable Bar #SBPB-CWS-6



optional lift-up end countertop

SPEC-BAR® Portable Bar combines Eagle Group's most popular back bar equipment with a rugged stainless steel tubular frame to create a compact and capable mobile workstation. The 48" workboard, large ice bin, full length double speed rail make this workstation a workhorse.

For custom configuration or fabrication needs, contact our **SpecFAB® Division**.

Phone: (302) 653-3000. FAX: (302) 653-2065.

E-mail: quotes@eaglegrp.com





Profit from the Eagle Advantage®

SPEC-BAR® Portable Bar with Workboard

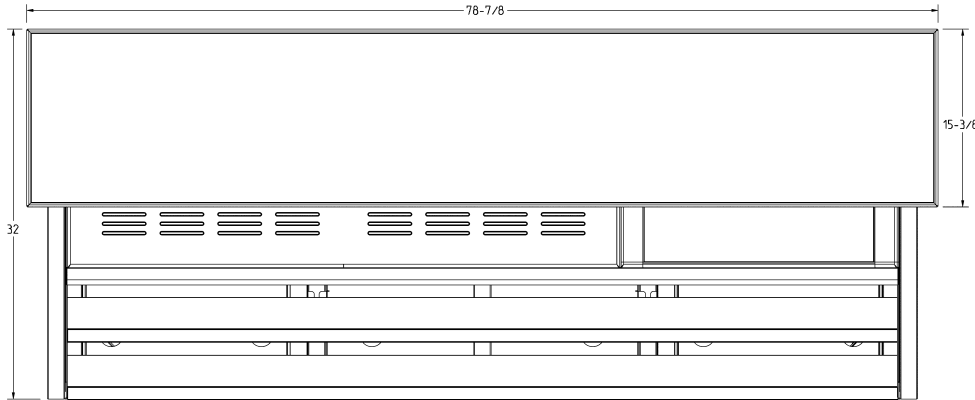

TOP VIEW

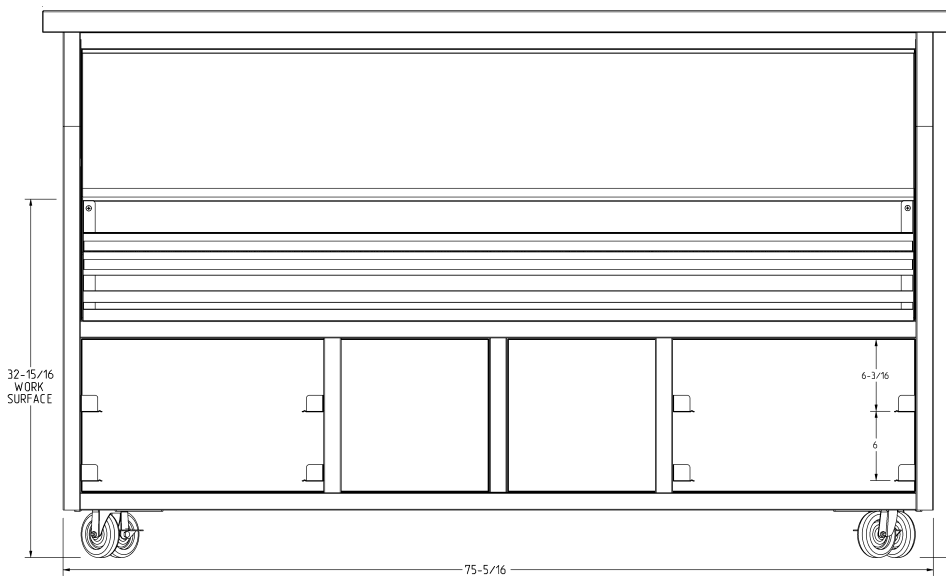

FRONT VIEW (WORKER'S SIDE)

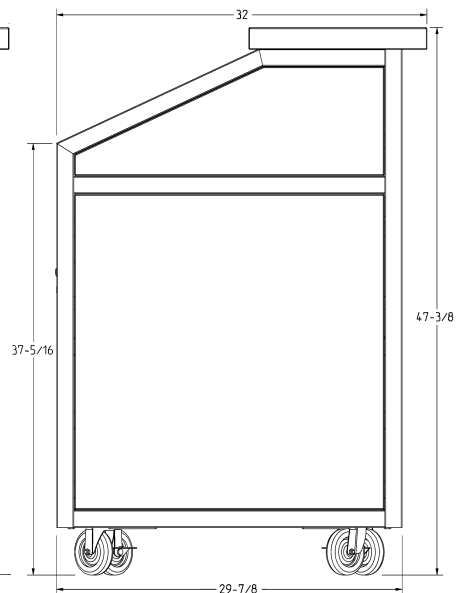

SIDE VIEW

O.A. size (length x width x height)		working height		model #
in.	mm	in.	mm	
80" x 32" x 48"	2032 x 818 x 1219	34"	864	SBPB-CWS-6

Printed in U.S.A.
©2023 by Eagle Group

EG8215CWS Rev. 01/23

Phone: (800) 441-8440 or (302) 653-3000 • Fax: (302) 653-2065 • www.eaglegrp.com • www.eaglegrpnews.com • www.eaglehmc.com

Although every attempt has been made to ensure the accuracy of the information provided, we cannot be held responsible for typographical or printing errors. Information and specifications are subject to change without notice. Please confirm at time of order.