



Profit from the Eagle Advantage®

Phone: (800) 441-8440 • (302) 653-3000

FAX: (302) 653-2065

Product Announcement

Short Form Specifications

Eagle Spec-Bar® Drop-In Glass Rinser Trough, model _____. Heavy gauge type 300 stainless drain trough. Glass rinser features a 4½"-diameter actuation disk, comes with 12" long braided stainless hose with a ¾" compression fitting and a ½" FIP fitting. Inline, preset pressure regulator provided. Removable stainless steel trough cover. ½" drain with barbed drain fitting provided.

Item #:	_____
Model #:	_____
Project #:	_____
SIS #:	_____

EG8185 Rev. 01/23

New Spec-Bar® Drop-In Glass Rinser Troughs

Design and Construction Features:

- Type 300 series stainless steel construction
- 4½" -diameter actuation disk
- ½" FNPT stainless steel fitting welded to pan for drain
- Inline preset pressure regulator
- Removable stainless steel trough cover
- Lengths available range from 6" to 24"

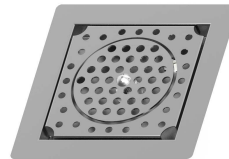

#DIGRT-6

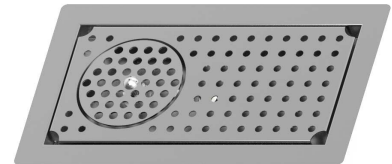

#DIGRT-12

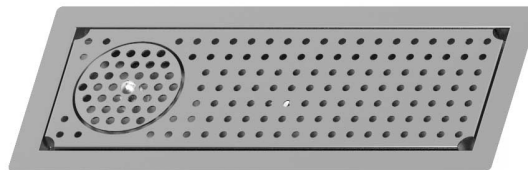

#DIGRT-18

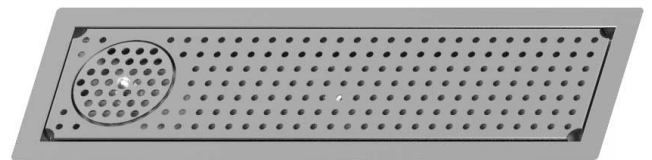

#DIGRT-24

Every bartender wants a perfect pour. By rinsing the glass before pouring, you rinse away any impurities and condition the glass for that perfect pour. Eagle's NEW Drop-In Glass Rinser Troughs are easy to use: Turn a glass upside-down, place it on the glass rinser, and push down to activate it. It's that easy! Sits flush with the countertop! Cover is removable for ease of cleaning.

Choose from four models ranging from six inches to 24 inches in length.

For custom configuration or fabrication needs, contact our **SpecFAB® Division**.

Phone: (302) 653-3000. FAX: (302) 653-2065.

E-mail: quotes@eaglegrp.com



Eagle Spec-Bar® Drop-In Glass Rinsing Troughs

#DIGRT-6

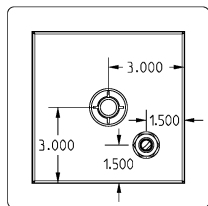
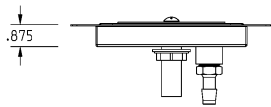
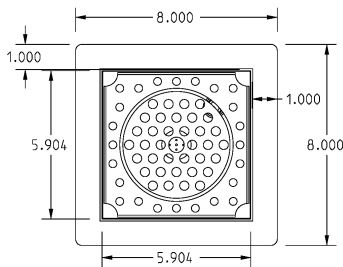

CUTOUT DIMENSIONS
(width x length)
6 1/4" x 6 1/4"
(159 x 159mm)

#DIGRT-12

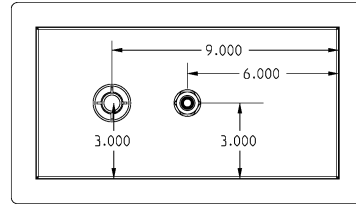
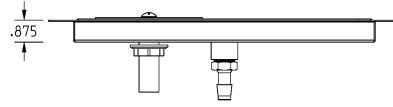
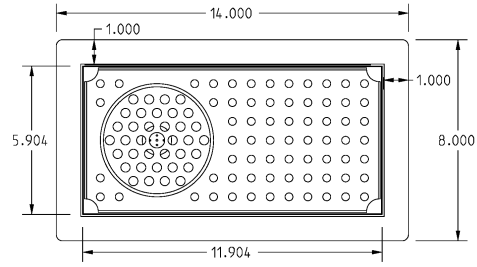

CUTOUT DIMENSIONS
(width x length)
6 1/4" x 12 1/4"
(159 x 311mm)

#DIGRT-18

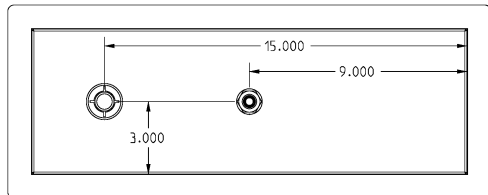
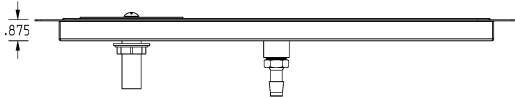
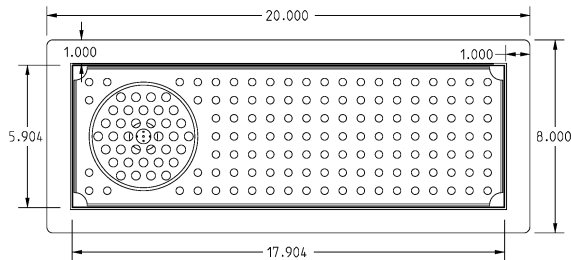

CUTOUT DIMENSIONS
(width x length)
6 1/4" x 18 1/4" (159 x 464mm)

#DIGRT-24

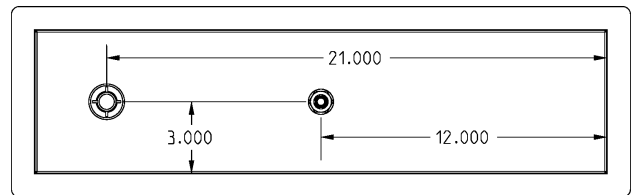
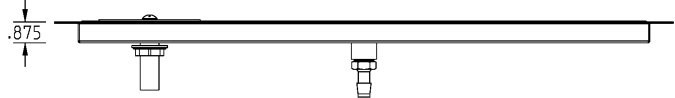
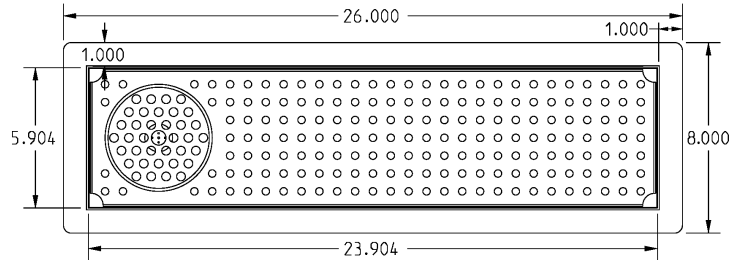

CUTOUT DIMENSIONS
(width x length)
6 1/4" x 24 1/4" (159 x 616mm)