

Drawers for Tables with Angle Frame

(Drawers #500772, 501571, 502941, and 502942)

ASSEMBLY INSTRUCTIONS

Parts List

#	qty	part #	description
#1	2	336255	Drawer Mounting Bracket
#2	4	313630	#12 x 3/4" Drive Screw
#3	2	300697	18" Drawer Slide
#4	4	301492	#10 Lock Washer
#5	4	300755	#10-24 Hex Nut
#6	1		Drawer Pan

Before assembly:

- Determine applicable sets of holes in brackets.

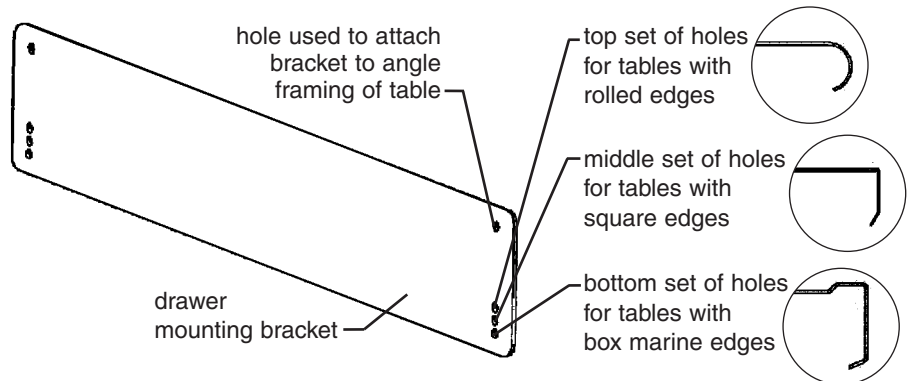

Step 1

Locate the two screw holes nearest to each end of either drawer slide.

Step 2

Attach drawer slides to drawer brackets using hardware included.

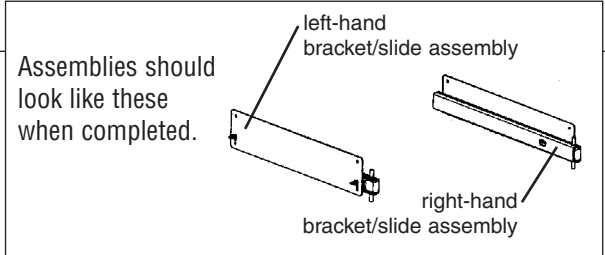

Drawers for Tables with Angle Frame

(Drawers #500772, 501571, 502941, and 502942)

ASSEMBLY INSTRUCTIONS

Step 3

Underneath tabletop, attach bracket/slide assemblies to angle framing of table using hardware included.

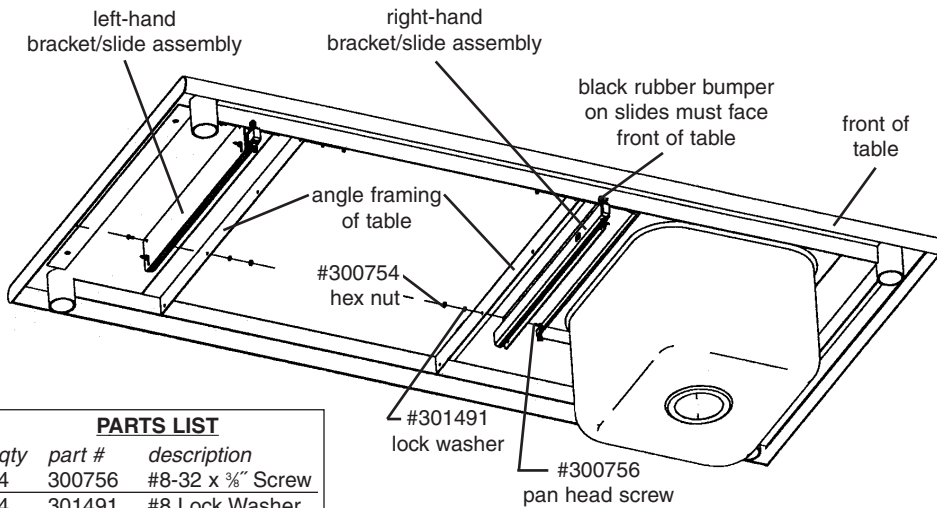

PARTS LIST

qty	part #	description
4	300756	#8-32 x 3/8" Screw
4	301491	#8 Lock Washer
4	300754	#8-32 Hex Nut

Step 4

Remove the black cap from the top of each pin. Set aside but DO NOT LOSE.

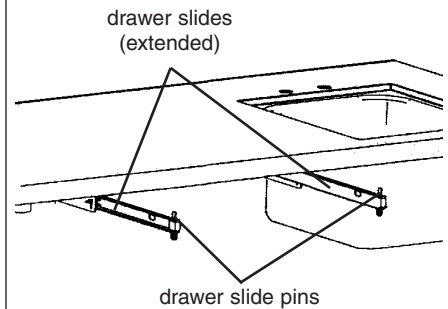

Step 5

Lay drawer on top of drawer slides, aligning holes in drawer to pin of each slide.

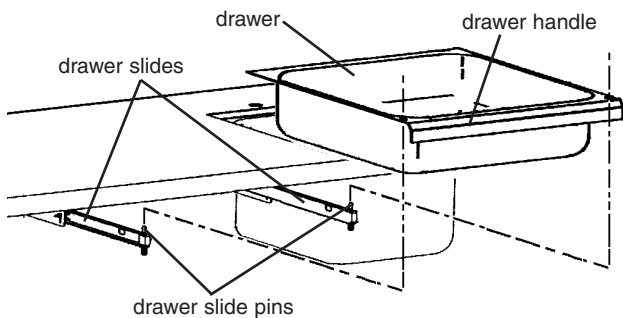

Step 6

Return black rubber caps to both pins.

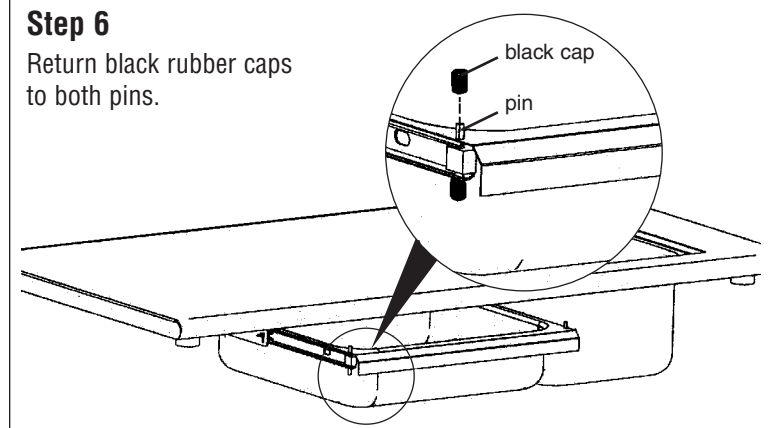

Profit from the Eagle Advantage®

- 100 Industrial Boulevard, Clayton, Delaware 19938-8903 U.S.A. • www.eaglegrp.com
- Phone: 302/653-3000 • (Foodservice) 800/441-8440 • (MHC/Retail) 800/637-5100
- Fax: 302/653-2065 or 302/653-3036