



Convenience Store Modular Cabinets



EAGLE[®]
GROUP
Profit from the Eagle Advantage[®]

www.eaglegrp.com

Product Line Overview

Convenience Store Modular Cabinets

A Cost Effective Option to Fully Custom Counters



Eagle's convenience store cabinets feature modular components for convenience stores which can utilize a common top or be configured with separate tops in a scatter system configuration. Top options include laminates, solid surface, stone, granite or stainless steel.

Modular pieces can mix and match based on store requirements.

- Open Base Cabinets
- Closed Base Cabinets
- Open Base Wall Cabinets
- Closed Base Wall Cabinets
- Beverage Counters
- Cup/Lid Towers
- Merchandisers
- Trash Cabinets
- Angled Corner Cabinets
- Sink Base Cabinets
- Coffee Station Counters
- Condiment Counters
- Island Counters



Standard Cabinet Features

Cabinet Construction

Powder-coated galvanized steel cabinet. Black or gray standard colors available. Customized color options per customer requirements (optional stainless steel and millwork also available). Top overhang creates utility chase at rear. Back panel with opening to chase area. 4 1/2"-tall curb base with toe-kick and leveling feet. Access to inside of curb base from inside by removable bottom panel.

Door Construction

Inset doors constructed with 4" wire pull (two doors on units 30" and longer). Options for doors include keyed locks, perforations and louvers. Custom door options: Plastic laminates, solid materials, and wood; various colors and pulls; and vinyl wrapping.

Top Options Available (Tops Made to Order)

Beverage trough with drain; plastic laminates; stainless steel; solid surface materials; stone; powder-coated steel.

Cabinet Dimensions

18" and 22" depths (front-to-back); 12", 18", 24", 30", 36", and 48" lengths (end-to-end), except where noted; Nominal 34" and 25" heights.

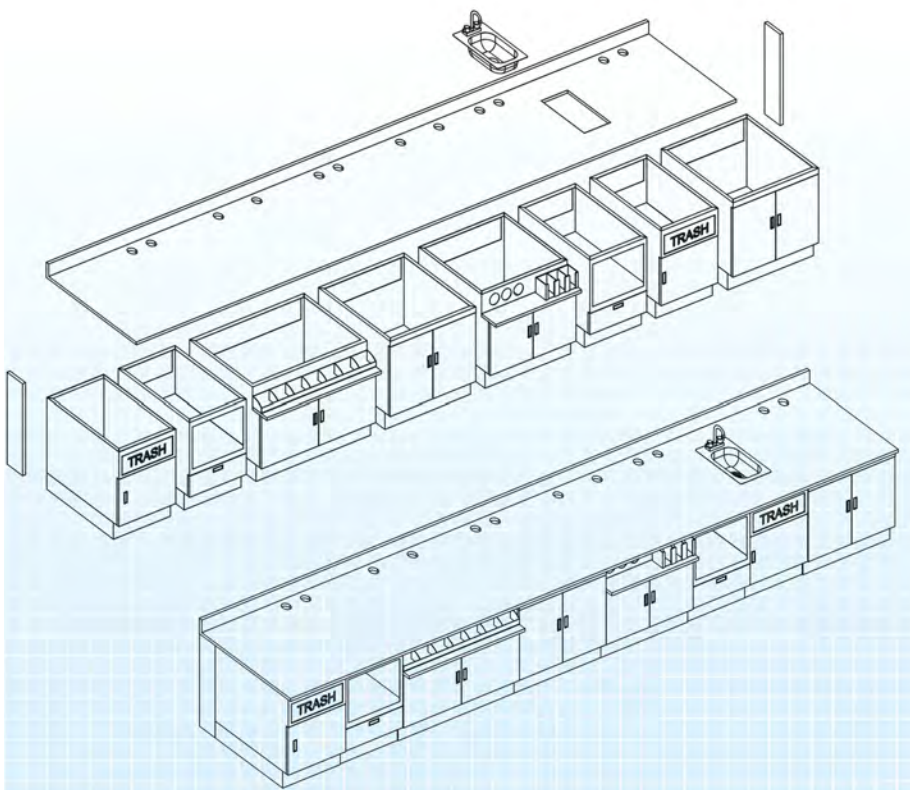

Our experienced design team can assist you with cabinet layout, elevations, equipment listings, CAD drawings and Revit files and specification documents, to assist in your project quotation submissions.



Revit C-Store Cabinet

Cabinets

Open Base Cabinets

- Removable back panel.
- Removable bottom panel.
- Interior shelves - fixed or pullout options available.



Closed Base Cabinets

- Two Door base - hinged or sliding doors available
- Drawer and doors combination cabinet
- Drawer bank cabinet



Sink Base Cabinets

- Open back panel
- Partial removable bottom panel for plumbing access
- Self rimming sink provided with 1 1/2" basket drain included.
- Deck mounted faucet provided. Options include electronic-eye, wrist handles, soap dispenser and towel dispenser.



Safe Base

- Open base style to accommodate separate safe.
- Curbed base.
- Leveling base feet.



Island Door Cabinet

- Open back panel
- Available with hinged doors
- Curbed base design.



Condiment and Trash Units

Condiment Units

- Recessed area with stainless ledge for condiment trays
- One adjustable center shelf
- Condiment trays 6" deep. Includes adjustable dividers.



Mitered Island Condiment Cabinet

- Recessed area with stainless ledge for condiment trays
- Space saving mitered design.
- Condiment trays 6" deep. Includes adjustable dividers.



Drop In Trash Cabinets

- Full back panel.
- Removable bottom panel.
- One door and trash flap.



Trash Chute Cabinets

- Full back panel.
- Removable bottom panel.
- One door and trash flap.



Pull Out Trash Cabinets

- Full back panel.
- Removable bottom panel.
- Pull out shelf and trash flap.



Beverage Units & Cup Towers

Beverage Counters

- Recessed area with stainless steel ledge for cup dispensers (sold separately)
- One adjustable center shelf
- Optional condiment trays available
- Option lid holders available



Mitered Island Beverage Units

- Recessed area with stainless steel ledge for cup dispensers (sold separately)
- Front and side doors available.
- Optional condiment trays available
- Mitered design saves floor space



Countertop Cup Towers

- Countertop design for use on separate base cabinet
- Standard cup tower
- Cup tower with straw holder
- Cup tower with lid and straw holders



Cup Towers

- Available with storage base or trash receptacle
- Standard cup tower
- Cup tower with straw holder
- Cup tower with lid and straw holders



Merchandisers and Wall Cabinets

Merchandisers

- *Inset merchandising shelving*
- *Single and double sided units available.*
- *Display and accent lighting options.*



Slat Wall Merchandisers

- *Slat Wall Center Inset*
- *Can be wired for display and accent lighting options*
- *Inset merchandising shelving*
- *Single and double sided units available.*



Cigarette Pusher Cabinets

- *Three interior shelves.*
- *Features pull out shelf option with cigarette pusher.*
- *Curb base.*
- *Leveling feet provided.*



Wall Cabinets

- *Open wall cabinet features two interior shelves*
- *Closed wall cabinet features two hinged doors.*

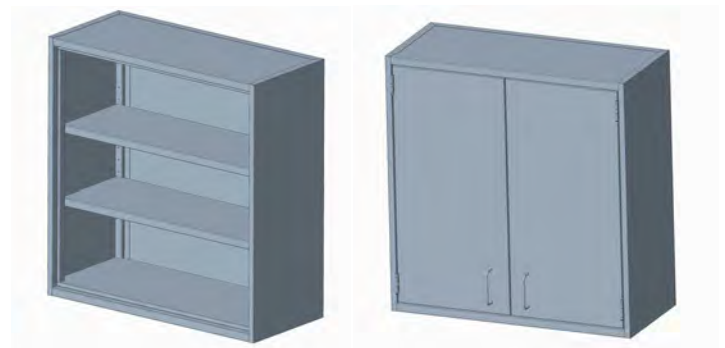

Options & Accessories

Merchandising Shelves



Filler Panels & Toe Scribes

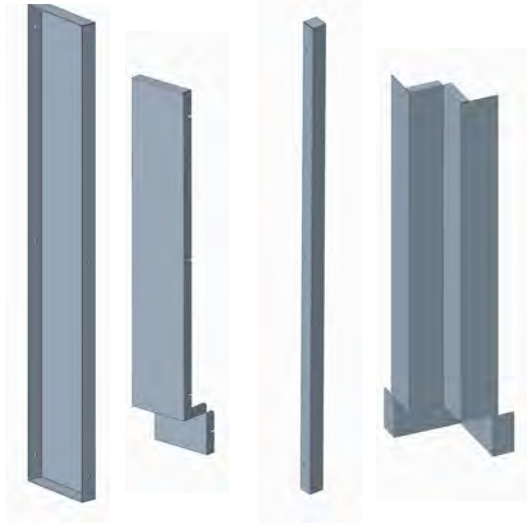

Lid Holder



Condiment Holder



Pull Out Shelves



Curved End Cabinet Option



Top Finish Options

- Plastic Laminates
- Stone
- Wood
- Solid surface
- Powder Coated Steel
- Stainless steel countertops

Base Finish Options

- Plastic Laminates
- Powder Coated Steel - Custom Colors
- Stainless Steel
- Millwork
- Vinyl Wrapping and Custom logos

Lighting Options

- Display and Accent Lighting Options Available

Eagle Group

100 Industrial Blvd.
Clayton, DE 19938

Toll Free:

1-800-441-8440 (FDSRV)

Fax: 302-653-2065

www.eaglegrp.com



How to Request a Quote?

- Quotation request get emailed to quotes@eaglegrp.com
- Fax 302-653-3091 to...
Eagle Group, Attn: SpecFAB Quote Department, 100 Industrial Blvd, Clayton, DE 19938

What to include with your request...

- Your name and dealer name
- Job or project name
- Required date for quote
- Bid date for project
- Projected installation date and timeline
- Consultant name when applicable
- Plans and specifications related to the project
- Special considerations

EAGLE
GROUP[®]
Profit from the Eagle Advantage[®]

EG7013 Rev. 10/18