



# Top-Mount Countertop Drop-In Self-Rim Design Sinks

## INSTALLATION INSTRUCTIONS

### Step 1 - Cut the hole for the sink.

Refer to the "Cutout Dimensions" chart on front page.

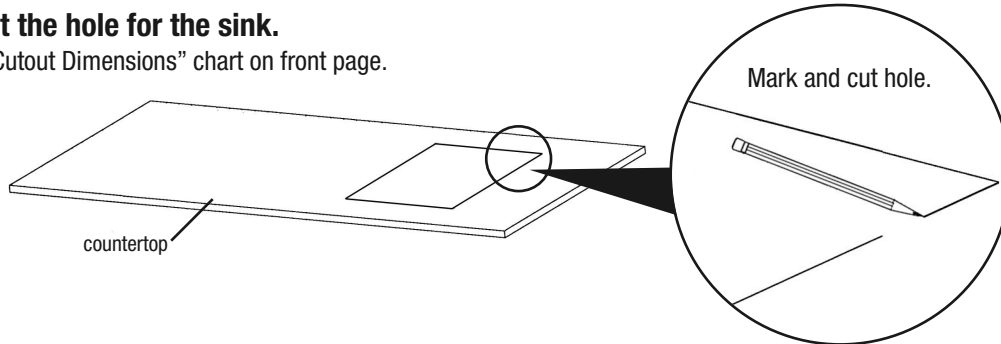

### Step 2 - Caulk under the outside edge of the top flange.

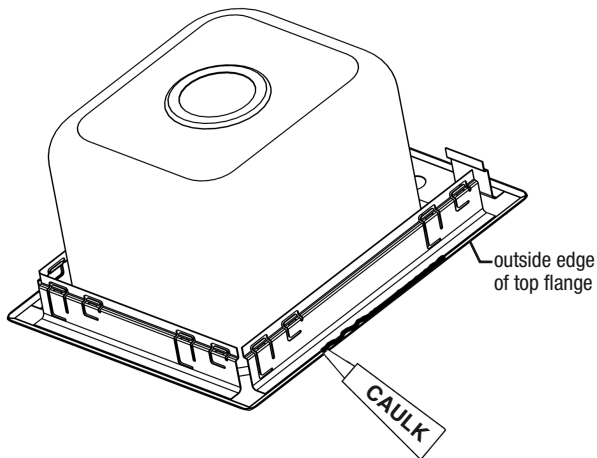

### Step 3 - Carefully place the sink inside the cutout.

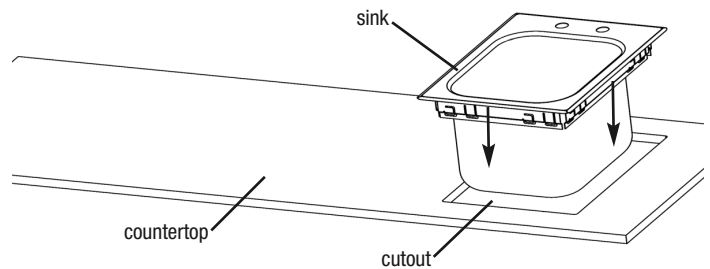

### Step 4 - Secure sink.

Using a flat screwdriver, twist applicable tabs out and up to secure the sink.

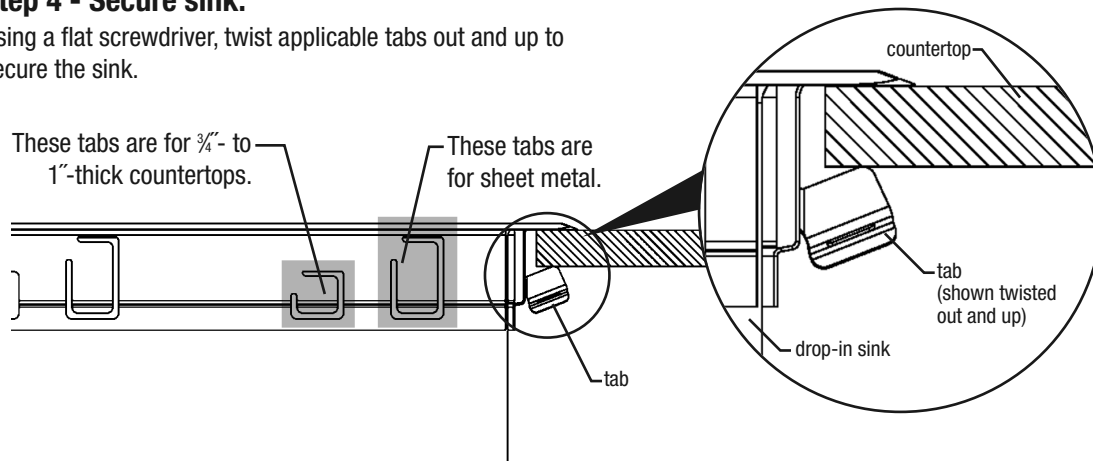

(End)



# Bottom-Mount Countertop Self-Rim Design Sinks

## INSTALLATION INSTRUCTIONS

### Step 1 - Cut the hole for the sink.

- Refer to the cutout template included with sink.
- Referring to “BOTTOM MOUNTING” verbiage on the template, transfer the dimensions to the countertop (do not forget the faucet holes).
- Cut the hole.
- Finish the edge of the cutout, using a router and desired router bit.

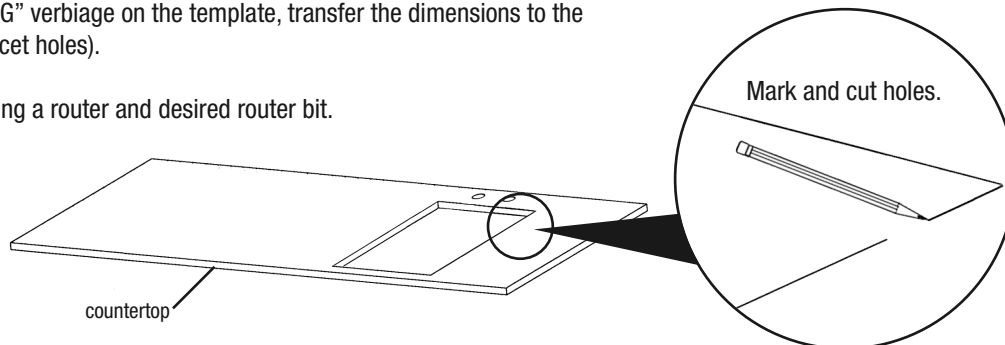

### Step 2 - Caulk the top of the flange.

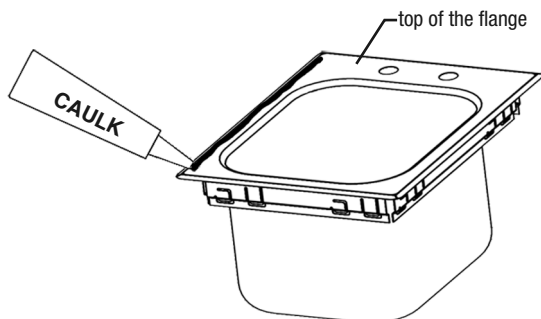

### Step 3 - Place the sink under the cutout.

A second person, or a temporary prop, might be needed to hold the sink in place.

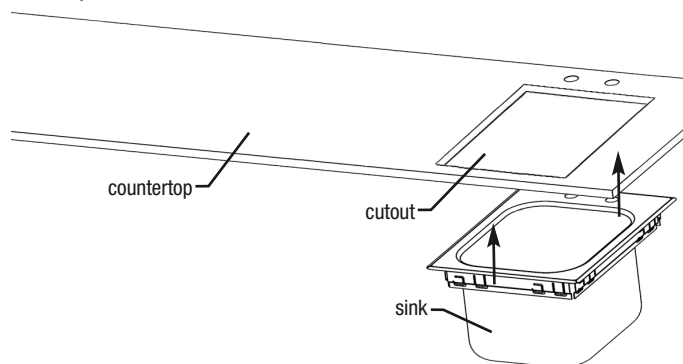

### Step 4 - Secure sink.

Use kit #362188 (sold separately) as shown.  
Screws, washers, etc. not included.

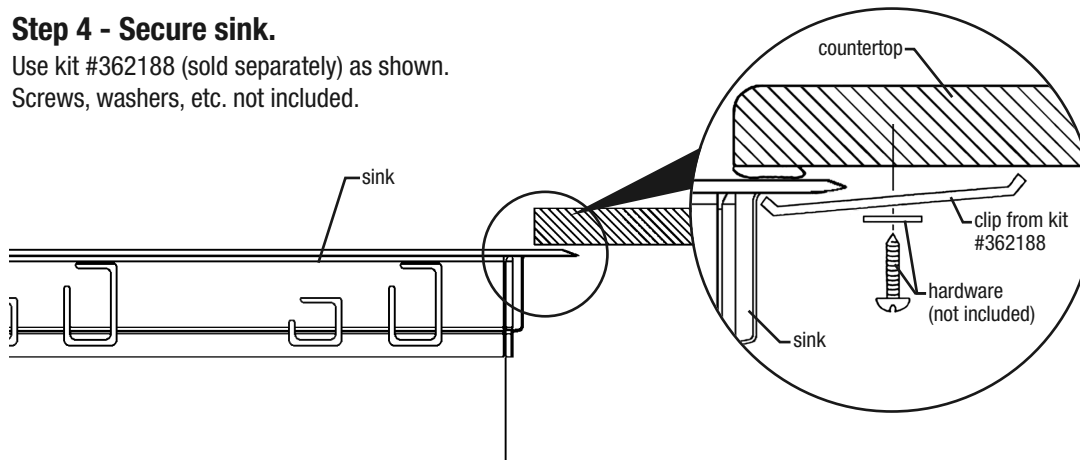

(End)