

# Hand Sink with Wall Brackets

## ASSEMBLY INSTRUCTIONS

For Narrow Hand Sink with Wall Brackets, see previous page.

### CAUTION

INSPECT CONTENTS IMMEDIATELY AND FILE CLAIM WITH DELIVERING CARRIER FOR ANY DAMAGE.

**SAVE YOUR BOX AND ALL PACKING MATERIALS.**

YOU ARE RESPONSIBLE FOR DAMAGE TO YOUR UNIT IF RETURNED IMPROPERLY PACKED.

#### Please note before assembly:

Remove the locking nuts from underside of hand sink and set aside.

### Step 1 - Assemble wall brackets to sink.

- Align holes on top of bracket with threaded studs underneath sink, and assemble.
- Fasten with nuts provided.
- Repeat on remaining side of sink.

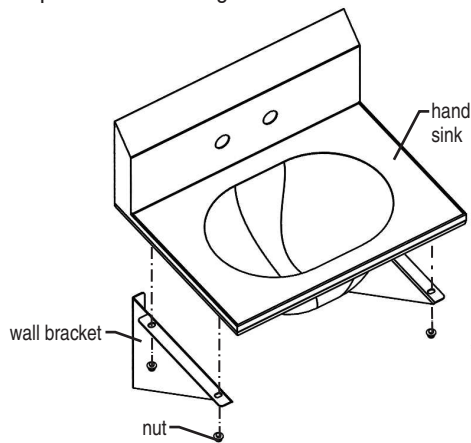

### Step 2 - Mount z-bracket to wall.

Use a level for straightness.

(Note: Mounting hardware not included.)

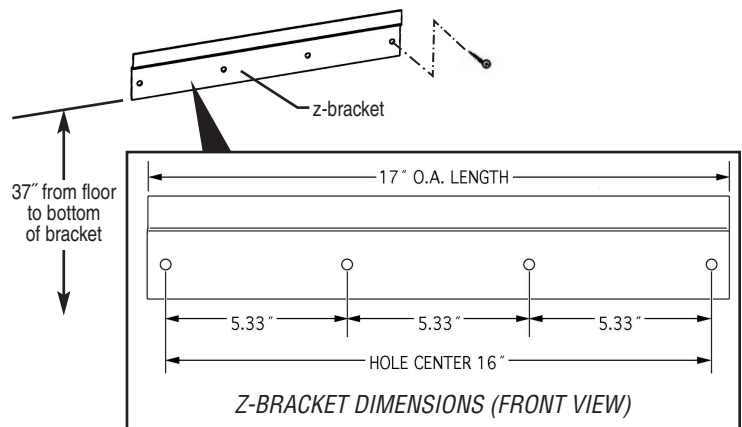

### Step 3 - Hang sink off z-bracket.

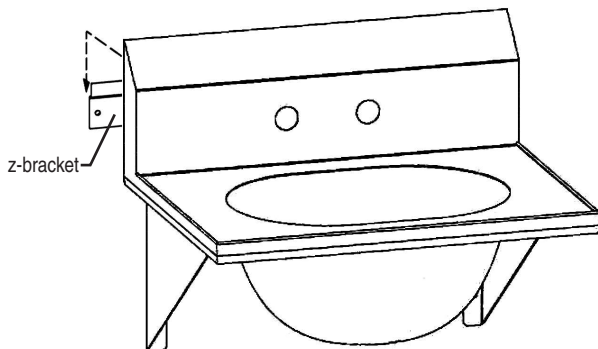

### Step 4 - Secure wall brackets to wall.

(Note: Mounting hardware not included.)

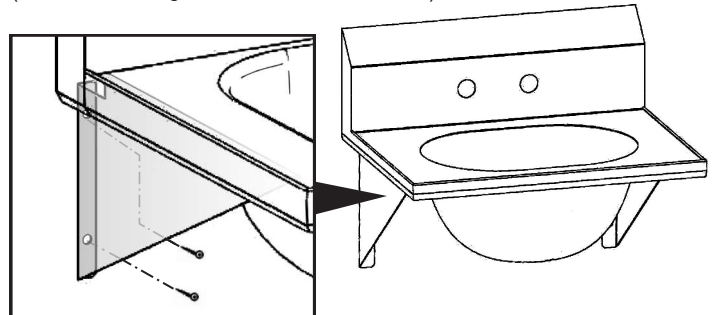

(End)

EG9945 Revised 04/12

# Narrow Hand Sink with Wall Brackets

## ASSEMBLY INSTRUCTIONS

For Hand Sink with Wall Brackets, see next page.

### CAUTION

INSPECT CONTENTS IMMEDIATELY AND FILE CLAIM WITH DELIVERING CARRIER FOR ANY DAMAGE.

**SAVE YOUR BOX AND ALL PACKING MATERIALS.**

YOU ARE RESPONSIBLE FOR DAMAGE TO YOUR UNIT IF RETURNED IMPROPERLY PACKED.

#### Please note before assembly:

Remove the locking nuts from underside of hand sink and set aside.

### Step 1 - Assemble wall brackets to sink.

- Align holes on top of bracket with threaded studs underneath sink, and assemble.
- Fasten with nuts provided.
- Repeat on remaining side of sink.

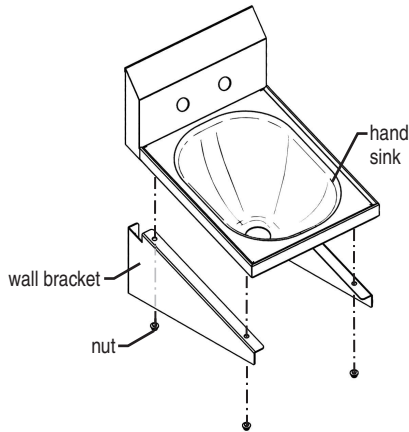

### Step 2 - Mount z-bracket to wall.

Use a level for straightness.

(Note: Mounting hardware not included.)

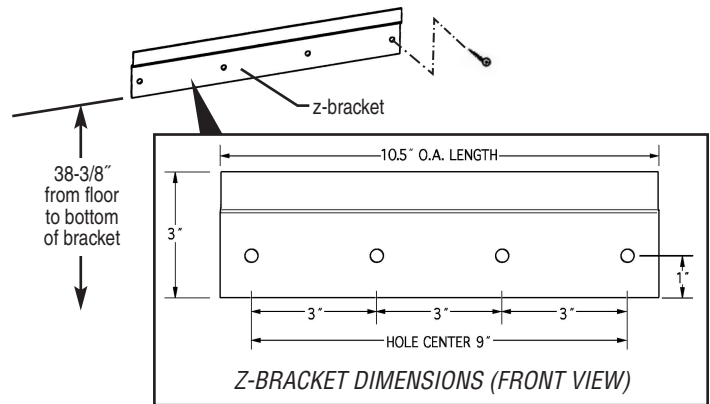

### Step 3 - Hang sink off z-bracket.

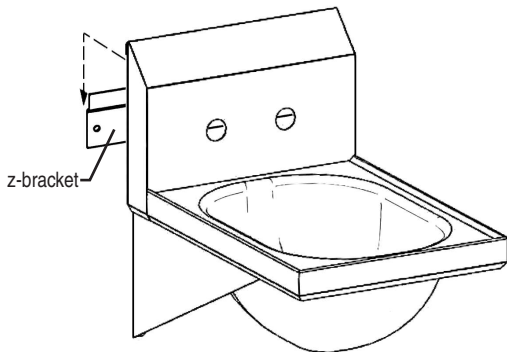

### Step 4 - Secure wall brackets to wall.

(Note: Mounting hardware not included.)

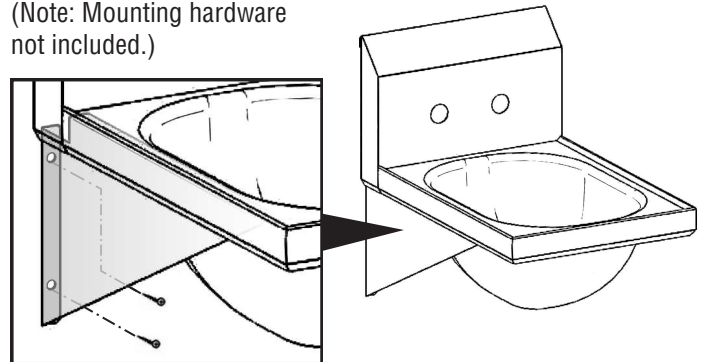

(End)