



Profit from the Eagle Advantage®

# Specification Sheet

## Short Form Specifications

Eagle Anti-Splash Floor Trough with stainless steel grating, model \_\_\_\_\_. Unit constructed of 14/304 stainless steel all-welded construction. Patented anti-splash design (patent #D519,618 S) assures complete drainage while preventing splash back onto the floor. Drain accommodates up to a 4"-diameter pipe and comes standard with a stainless steel removable perforated basket. Type 304 stainless steel subway style grating shall be 5/8" x 1" vertically positioned bars spaced 1" apart for ease of drainage. Two 5/8" stainless steel rods, set 2 1/4" in from each edge, are welded to the bars to eliminate swaying.

Eagle Anti-Splash Floor Trough with fiberglass grating, model \_\_\_\_\_. Unit constructed of 14/304 stainless steel all-welded construction. Patented anti-splash design (patent #D519,618 S) assures complete drainage while preventing splash back onto the floor. Drain accommodates up to a 4"-diameter pipe and comes standard with a stainless steel removable perforated basket. Fiberglass grating to be 1" high yellow polyester material with a non-slip grit surface. Tapered "I" beam construction for ease of cleaning and drainage. Gray color grating available.



anti-splash floor trough

### Options / Accessories

- Gray color fiberglass grating
- ADA-compliant grating

### EAGLE GROUP

100 Industrial Boulevard, Clayton, DE 19938-8903 USA

Phone: 302-653-3000 • Fax: 302-653-2065

www.eaglegrp.com

Foodservice Division: Phone 800-441-8440

MHC/Retail Display Divisions: Phone 800-637-5100

For custom configuration or fabrication needs, contact our SpecFAB® Division.

Phone: 302-653-3000 • Fax: 302-653-3091 • e-mail: specfab@eaglegrp.com

Item No.:	_____
Project No.:	_____
S.I.S. No.:	_____

## Anti-Splash Floor Troughs

### MODELS:

- |                                       |                                       |                                       |
|---------------------------------------|---------------------------------------|---------------------------------------|
| <input type="checkbox"/> ASFT-1218-*  | <input type="checkbox"/> ASFT-1548-*  | <input type="checkbox"/> ASFT-1884-*  |
| <input type="checkbox"/> ASFT-1224-*  | <input type="checkbox"/> ASFT-1560-*  | <input type="checkbox"/> ASFT-1896-*  |
| <input type="checkbox"/> ASFT-1230-*  | <input type="checkbox"/> ASFT-1572-*  | <input type="checkbox"/> ASFT-18120-* |
| <input type="checkbox"/> ASFT-1236-*  | <input type="checkbox"/> ASFT-1584-*  | <input type="checkbox"/> ASFT-2424-*  |
| <input type="checkbox"/> ASFT-1248-*  | <input type="checkbox"/> ASFT-1596-*  | <input type="checkbox"/> ASFT-2430-*  |
| <input type="checkbox"/> ASFT-1260-*  | <input type="checkbox"/> ASFT-15120-* | <input type="checkbox"/> ASFT-2436-*  |
| <input type="checkbox"/> ASFT-1272-*  | <input type="checkbox"/> ASFT-1824-*  | <input type="checkbox"/> ASFT-2448-*  |
| <input type="checkbox"/> ASFT-1284-*  | <input type="checkbox"/> ASFT-1830-*  | <input type="checkbox"/> ASFT-2460-*  |
| <input type="checkbox"/> ASFT-1296-*  | <input type="checkbox"/> ASFT-1836-*  | <input type="checkbox"/> ASFT-2472-*  |
| <input type="checkbox"/> ASFT-12120-* | <input type="checkbox"/> ASFT-1848-*  | <input type="checkbox"/> ASFT-2484-*  |
| <input type="checkbox"/> ASFT-1524-*  | <input type="checkbox"/> ASFT-1860-*  | <input type="checkbox"/> ASFT-2496-*  |
| <input type="checkbox"/> ASFT-1530-*  | <input type="checkbox"/> ASFT-1872-*  | <input type="checkbox"/> ASFT-24120-* |
| <input type="checkbox"/> ASFT-1536-*  |                                       |                                       |

\* See chart on back for complete model numbers.

### Design and Construction Features

- Patented "anti-splash" design (patent #D519,618 S) assures complete drainage, while preventing splash back onto floor.
- 14 gauge type 304 stainless steel all-welded construction.
- Built-in pitch towards drain insures complete drainage.
- Stainless steel drain accommodates up to a 4" (102mm) diameter pipe, and features a removable perforated stainless steel basket.
- Comes with subway-style stainless steel grating or yellow fiberglass grating.
- Floor troughs with gray fiberglass grating available (in place of yellow). To order, add suffix "G" to model number of trough with yellow fiberglass grating. Example: ASFT-1224-FGG
- Floor troughs with ADA-compliant grating\* available. To order, add suffix "-ADA" to end of model number. Example: ASFT-1224-FG-ADA
- Custom sizes available. Consult factory for details.

\* For Floor Troughs with Fiberglass Grating, optional ADA-compliant Grating is wide T-Bar grey color fiberglass. For Floor Troughs with Stainless Steel Grating, optional ADA-compliant Grating features additional stainless steel flat bars spaced 1/4" apart.

### Certifications / Approvals



Spec sheets available for viewing, printing or downloading from our online literature library at [www.eaglegrp.com](http://www.eaglegrp.com)



Profit from the Eagle Advantage®

Item No.: \_\_\_\_\_  
 Project No.: \_\_\_\_\_  
 S.I.S. No.: \_\_\_\_\_

# Anti-Splash Floor Troughs

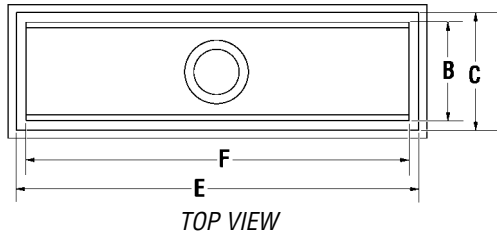
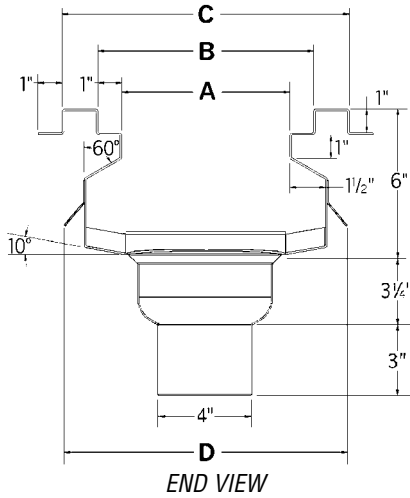

See chart below for dimensions A through F

### Grating Used in Various Floor Troughs

Floor Trough (dimension E)	Floor Trough (dimension F)	Grating Used - Quantity and Length
18" (457mm)	15" (381mm)	one 15" (381mm)
24" (610mm)	21" (533mm)	one 12" (305mm) and one 9" (229mm)
30" (762mm)	27" (686mm)	three 9" (229mm)
36" (914mm)	33" (838mm)	two 12" (305mm) and one 9" (229mm)
48" (1219mm)	45" (1143mm)	three 12" (305mm) and one 9" (229mm)
60" (1524mm)	57" (1448mm)	four 12" (305mm) and one 9" (229mm)
72" (1829mm)	69" (1753mm)	five 12" (305mm) and one 9" (229mm)
84" (2134mm)	81" (2057mm)	six 12" (305mm) and one 9" (229mm)
96" (2438mm)	93" (2362mm)	seven 12" (305mm) and one 9" (229mm)
120" (3048mm)	117" (2972mm)	nine 12" (305mm) and one 9" (229mm)

12" (305mm)-WIDE TROUGHs		15" (381mm)-WIDE TROUGHs		18" (457mm)-WIDE TROUGHs		24" (610mm)-WIDE TROUGHs		dimension E	dimension F
WITH YELLOW * FIBERGLASS GRATING model #	WITH STAINLESS GRATING model #	WITH YELLOW * FIBERGLASS GRATING model #	WITH STAINLESS GRATING model #	WITH YELLOW * FIBERGLASS GRATING model #	WITH STAINLESS GRATING model #	WITH YELLOW * FIBERGLASS GRATING model #	WITH STAINLESS GRATING model #		
ASFT-1218-FG	ASFT-1218-SG	n/a	n/a	n/a	n/a	n/a	n/a	18"	15"
ASFT-1224-FG	ASFT-1224-SG	ASFT-1524-FG	ASFT-1524-SG	ASFT-1824-FG	ASFT-1824-SG	ASFT-2424-FG	ASFT-2424-SG	24"	21"
ASFT-1230-FG	ASFT-1230-SG	ASFT-1530-FG	ASFT-1530-SG	ASFT-1830-FG	ASFT-1830-SG	ASFT-2430-FG	ASFT-2430-SG	30"	27"
ASFT-1236-FG	ASFT-1236-SG	ASFT-1536-FG	ASFT-1536-SG	ASFT-1836-FG	ASFT-1836-SG	ASFT-2436-FG	ASFT-2436-SG	36"	33"
ASFT-1248-FG	ASFT-1248-SG	ASFT-1548-FG	ASFT-1548-SG	ASFT-1848-FG	ASFT-1848-SG	ASFT-2448-FG	ASFT-2448-SG	48"	45"
ASFT-1260-FG	ASFT-1260-SG	ASFT-1560-FG	ASFT-1560-SG	ASFT-1860-FG	ASFT-1860-SG	ASFT-2460-FG	ASFT-2460-SG	60"	57"
ASFT-1272-FG	ASFT-1272-SG	ASFT-1572-FG	ASFT-1572-SG	ASFT-1872-FG	ASFT-1872-SG	ASFT-2472-FG	ASFT-2472-SG	72"	69"
ASFT-1284-FG	ASFT-1284-SG	ASFT-1584-FG	ASFT-1584-SG	ASFT-1884-FG	ASFT-1884-SG	ASFT-2484-FG	ASFT-2484-SG	84"	81"
ASFT-1296-FG	ASFT-1296-SG	ASFT-1596-FG	ASFT-1596-SG	ASFT-1896-FG	ASFT-1896-SG	ASFT-2496-FG	ASFT-2496-SG	96"	93"
ASFT-12120-FG	ASFT-12120-SG	ASFT-15120-FG	ASFT-15120-SG	ASFT-18120-FG	ASFT-18120-SG	ASFT-24120-FG	ASFT-24120-SG	120"	117"

Floor Trough with ADA-compliant grating available in both Fiberglass and Stainless Steel. To order, add suffix "-ADA". Example: ASFT1224-SG-ADA.  
 Note: Fiberglass ADA-compliant Grating features grey colored wide T-Bars. Stainless Steel ADA-compliant Grating features additional stainless steel flat bars, spaced 1/4" apart.

\* To order Floor Trough with Gray Fiberglass Grating instead of standard yellow, add suffix "G". Example: ASFT1224-FGG

**EAGLE GROUP**  
 100 Industrial Boulevard, Clayton, DE 19938-8903 USA  
 Phone: 302-653-3000 • Fax: 302-653-2065  
 www.eaglegrp.com

Foodservice Division: Phone 800-441-8440  
 MHC/Retail Display Divisions: Phone 800-637-5100

Printed in U.S.A.  
 ©2019 by Eagle Group

Rev. 05/19

Spec sheets available for viewing, printing or downloading from our online literature library at [www.eaglegrp.com](http://www.eaglegrp.com)

Although every attempt has been made to ensure the accuracy of the information provided, we cannot be held responsible for typographical or printing errors. Information and specifications are subject to change without notice. Please confirm at time of order.