



Profit from the Eagle Advantage®

Specification Sheet

Short Form Specifications

Eagle 2200 Series Modular Angle Fillers, model _____. Top, front, and backsplash to be heavy gauge type 304 stainless steel, with galvanized sides. (Front /Rear) filler available in 30°, 45°, 60°, and 90° angles. All units have predrilled mounting holes.

Eagle 2200 Series Modular Corner Drainboards, model _____. Top, front, and backsplash to be heavy gauge type 304 stainless steel with galvanized sides, and embossed work surface. #MRC-22 includes one 1 5/8" O.D. galvanized tubular leg with adjustable bullet foot. Both units have predrilled mounting holes.



front angle filler



rear angle filler



front corner drainboard



rear corner drainboard

Item No.:	_____
Project No.:	_____
S.I.S. No.:	_____

2200 Series Modular Angle Fillers and Corner Drainboards

MODELS:

- | | | |
|----------------------------------|----------------------------------|---------------------------------|
| <input type="checkbox"/> MF30-22 | <input type="checkbox"/> MF60-22 | <input type="checkbox"/> MRC-22 |
| <input type="checkbox"/> MR30-22 | <input type="checkbox"/> MR60-22 | <input type="checkbox"/> MFC-22 |
| <input type="checkbox"/> MF45-22 | <input type="checkbox"/> MF90-22 | |
| <input type="checkbox"/> MR45-22 | <input type="checkbox"/> MR90-22 | |

Modular Angle Fillers

- Stainless steel front and top.
- Galvanized steel sides.
- Joins 2200 Series units by the corners.
- Front and rear fillers available in angles of 30°, 45°, 60° and 90°.
- All units have predrilled mounting holes.

Modular Corner Drainboards

- All-welded construction.
- Galvanized panels attach to other equipment, stainless steel outer panels remain visible.
- Joins 2200 Series units by the corners.
- MRC-22 provided with one 1 5/8" (41mm)-diameter leg.
- All units have predrilled mounting holes.

EAGLE GROUP

100 Industrial Boulevard, Clayton, DE 19938-8903 USA
 Phone: 302-653-3000 • 800-441-8440 • Fax: 302-653-2065
www.eaglegrp.com
www.eaglemh.com

For custom configuration or fabrication needs, contact our SpecFAB® Division.
 Phone: 302-653-3000 • Fax: 302-653-2065 • e-mail: quotes@eaglegrp.com



EG40.58 Rev. 10/24

Spec sheets available for viewing, printing or downloading from our online literature library at our websites

Eagle Foodservice Equipment, Eagle MHC, and SpecFAB® are divisions of Eagle Group. ©2024 by the Eagle Group



Item No.: _____
 Project No.: _____
 S.I.S. No.: _____

2200 Series Modular Angle Fillers

30° Angle Fillers

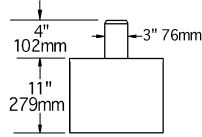
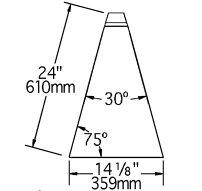

#MF30-22 Front Filler

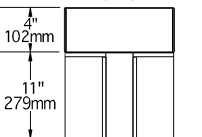
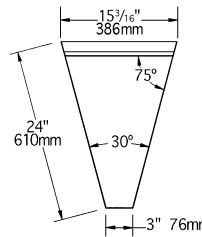

#MR30-22 Rear Filler

FRONT model #	REAR model #	weight lbs.	weight kg
MF30-22	MR30-22	16	7.3

45° Angle Fillers

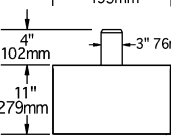
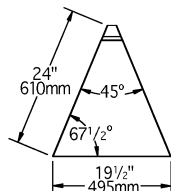

#MF45-22 Front Filler

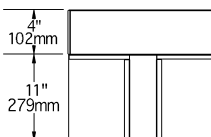
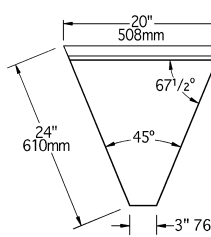

#MR45-22 Rear Filler

FRONT model #	REAR model #	weight lbs.	weight kg
MF45-22	MR45-22	17	7.7

60° Angle Fillers

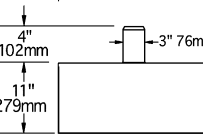
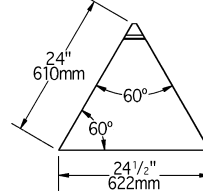

#MF60-22 Front Filler

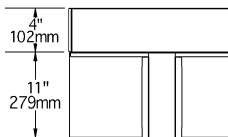
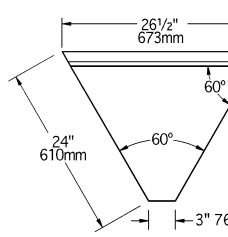

#MR60-22 Rear Filler

FRONT model #	REAR model #	weight lbs.	weight kg
MF60-22	MR60-22	20	9.0

90° Angle Fillers

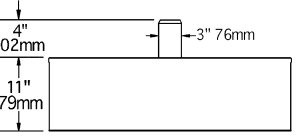
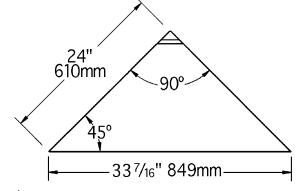

#MF90-22 Front Filler

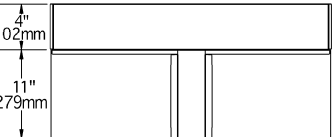
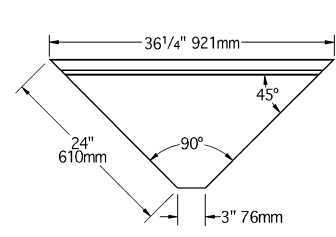

#MR90-22 Rear Filler

FRONT model #	REAR model #	weight lbs.	weight kg
MF90-22	MR90-22	22	10.0

Corner Drainboards – 2200 Series

FRONT model #	REAR model #	weight lbs.	weight kg
MFC-22	MRC-22	42	19.1

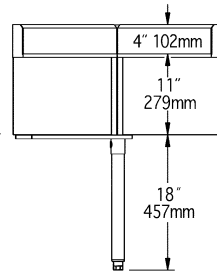
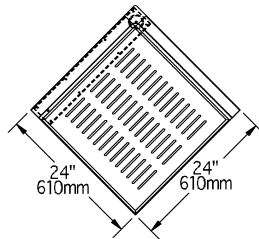

#MRC-22 Rear Corner Drainboard

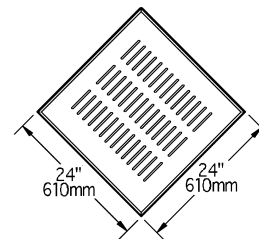

#MFC-22 Front Corner Drainboard

EAGLE GROUP
 100 Industrial Boulevard, Clayton, DE 19938-8903 USA
 Phone: 302-653-3000 or 800-441-8440 • Fax: 302-653-2065
 www.eaglegrp.com • www.eaglehmc.com

Printed in U.S.A.
 ©2024 by Eagle Group

Rev. 10/24

Spec sheets available for viewing, printing or downloading from our online literature library at our websites

Although every attempt has been made to ensure the accuracy of the information provided, we cannot be held responsible for typographical or printing errors. Information and specifications are subject to change without notice. Please confirm at time of order.